



Located in Swaffham centre, this spacious split level apartment boasts fitted kitchen, open lounge, 2 double bedrooms and modern bathroom. The property benefits from 1 off road parking space and is located within walking distance of many amenities.

Available: Beginning June 2025

Furnishing: Unfurnished

Council Tax: Band A

No smokers

No pets

Damage Deposit: £863.00

Holding Deposit: £172.00

#### Directions

From Swaffham Market Place, leave the centre of Swaffham via London Street and head straight over the mini roundabout and the property can be found on the right hand side above London Street Stores.

#### Location

Swaffham offers good general shopping facilities, a weekly market, doctors and dentist surgeries, a small hospital, leisure facilities and golf course.

EPC Rating: D/67.

GROUND FLOOR  
147 sq.ft. (13.6 sq.m.) approx.

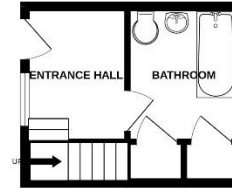

1ST FLOOR  
705 sq.ft. (65.5 sq.m.) approx.

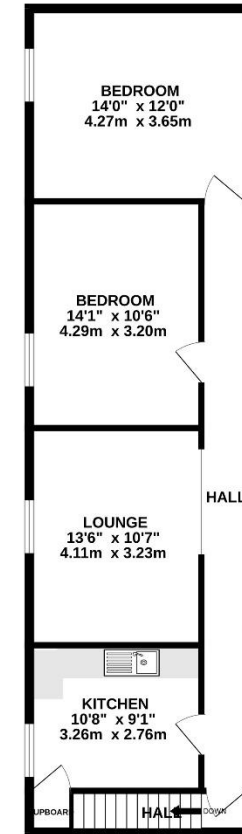

TOTAL FLOOR AREA : 852 sq.ft. (79.1 sq.m.) approx.

Whilst every attempt has been made to ensure the accuracy of the floorplan contained here, measurements of doors, windows, rooms and any other items are approximate and no responsibility is taken for any error, omission or mis-statement. This plan is for illustrative purposes only and should be used as such by any prospective purchaser. The services, systems and appliances shown have not been tested and no guarantee as to their operability or efficiency can be given.  
Made with Metropix ©2024

#### Dereham Office

37 Quebec Street, Dereham, NR19 2DJ

01362 696895

post@parsonsandcompny.co.uk

**PARSONS**  
COMPANY

#### Reepham Office

Market Place, Reepham, NR10 4JJ

01603 870473

info@parsonsandcompny.co.uk