



This modern & spacious ground floor flat which is located close to the centre of the town is available to move at the beginning of May. The flat benefits from 2 bedrooms, lounge/diner, fitted kitchen, bathroom and allocated off road parking.

Available: May 2025
Furnishing: Unfurnished
Council Tax: Band A

No smokers
No pets

Damage Deposit: £863.00
Holding Deposit: £172.00

Directions

To find the property leave Dereham Market Place by bearing right at the War Memorial, continuing along Wellington Road and taking the first right into Cowper Road. At the traffic lights continue straight over into Commercial Road and turn right opposite the Police Station into the car park, turning right immediately into Constable Court and the property will be seen as one of the two small blocks of two flats adjacent to Commercial Road. A 'To Let' board has been erected.

Location

Dereham is a well-served Breckland market town, located in the heart of Norfolk. The town offers a great mixture of excellent independent shops, national retailers, cafes and restaurants. Dereham has a good selection of primary and secondary education, with numerous bus connection from the town centre connecting the nearby villages.

NB: The photographs were taken prior to the current tenancy therefore are subject to change.

EPC Rating: TBC

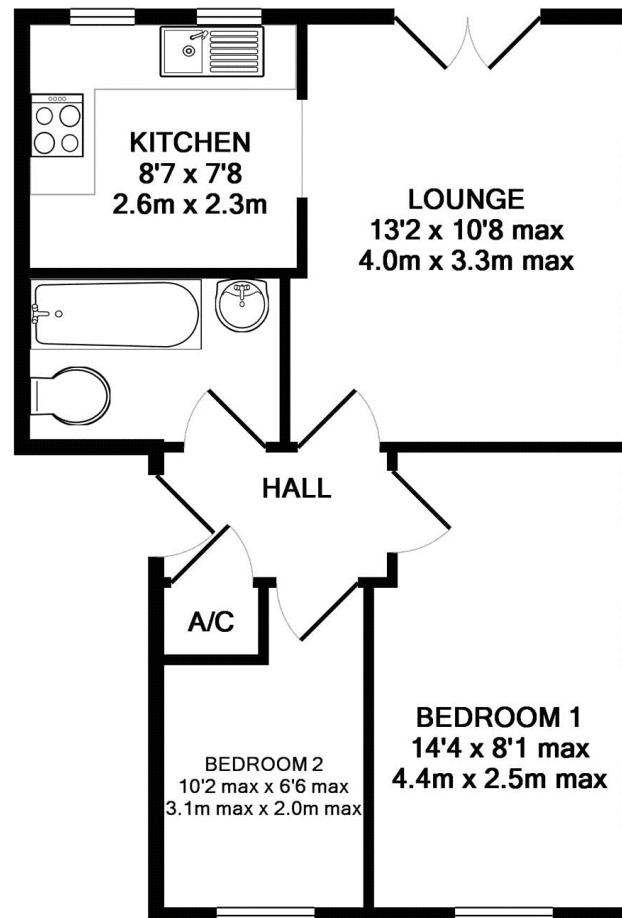

Measurements are approximate. Not to scale. Illustrative purposes only
Made with Metropix ©2014

Dereham Office

37 Quebec Street, Dereham, NR19 2DJ
01362 696895
post@parsonsandcompny.co.uk

PARSONS
&
COMPANY

Reepham Office

Market Place, Reepham, NR10 4JJ
01603 870473
info@parsonsandcompny.co.uk