

PARSONS
COMPANY



30 Burgh Lane, Mattishall, Dereham, NR20 3QP
£340,000



30 Burgh Lane, Mattishall, Dereham, NR20 3QP

£340,000

****No Onward Chain**** Offering huge potential is this three bedroom detached bungalow situated in the sought after location of Mattishall. This home benefits from an entrance hall with storage cupboards, spacious living room with double doors to dining area, fitted kitchen plus a further hall/utility area. Further on, there are three bedrooms with bedroom one being complemented by an en-suite shower room, with a family bathroom servicing the other bedrooms.

Outside to front, there is a gravelled front providing potential off-street parking once foliage is cleared, of which leads to a garage with a up/over door with power and lighting. To the rear, is a private garden with a grass area and flowerbeds whilst also benefiting from field views.

For room measurements please click on the floor plan option.

Location

Mattishall is a large, popular village 4 miles from Dereham. The village offers a wide range of useful local amenities including a Post office, doctors surgery, pharmacy, two convenience stores, take away, café and public house. Mattishall is a family friendly village with primary school and regular bus services into Dereham and Norwich City centre - which is roughly 10 miles away.

Description



Situation



null

Council Tax Band: C

Available:

Floor Plans

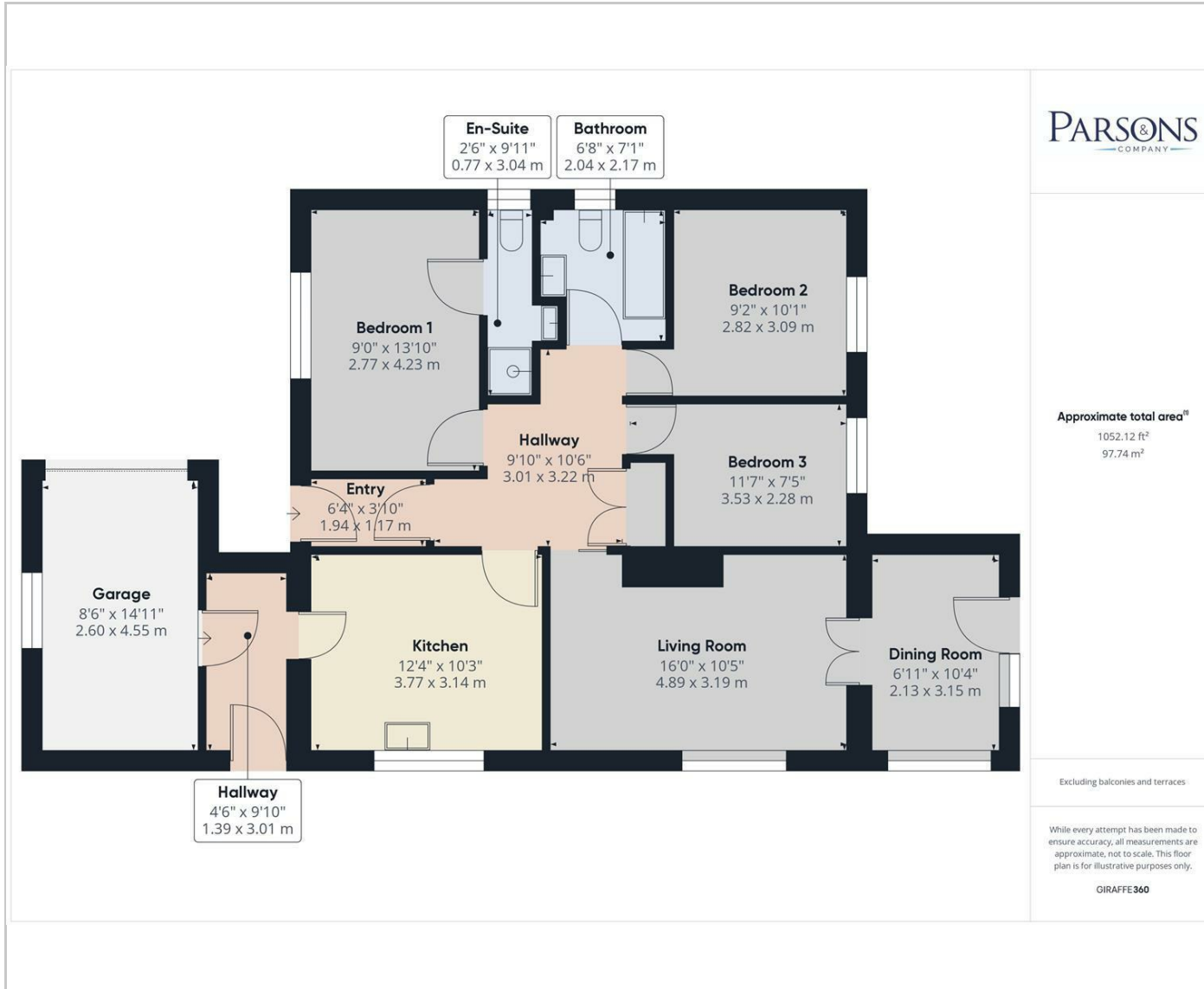

Area Map



Energy Performance Graph

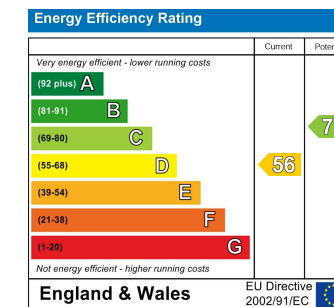

These particulars, whilst believed to be accurate are set out as a general outline only for guidance and do not constitute any part of an offer or contract. Intending purchasers should not rely on them as statements of representation of fact, but must satisfy themselves by inspection or otherwise as to their accuracy. No person in this firm's employment has the authority to make or give any representation or warranty in respect of the property.