



**MICHAEL EVERETT & Co**

*... A Moving Experience*



# 36 HEATHSIDE COURT

TADWORTH  
KT20 5RY

Located on the first floor with a pleasant outlook to the front and rear a particularly bright and spacious first floor apartment with lift access in this popular retirement development located midway between Tadworth and Walton on the Hill villages.

The apartment is in excellent condition having been redecorated, newly re-carpeted and fully modernised and features a large living room with lounge and dining areas, a new kitchen including appliances, two bedrooms both with fitted wardrobes and a new shower room, and a large loft storage space.

Outside, there are areas of well-maintained gardens including an allocated parking space and visitor car park and a popular residents day room used for regular social gatherings.

The property is offered for sale with no on-going chain and with the benefit of a new lease with an unexpired term of 158 years.

**ASKING PRICE £279,000**

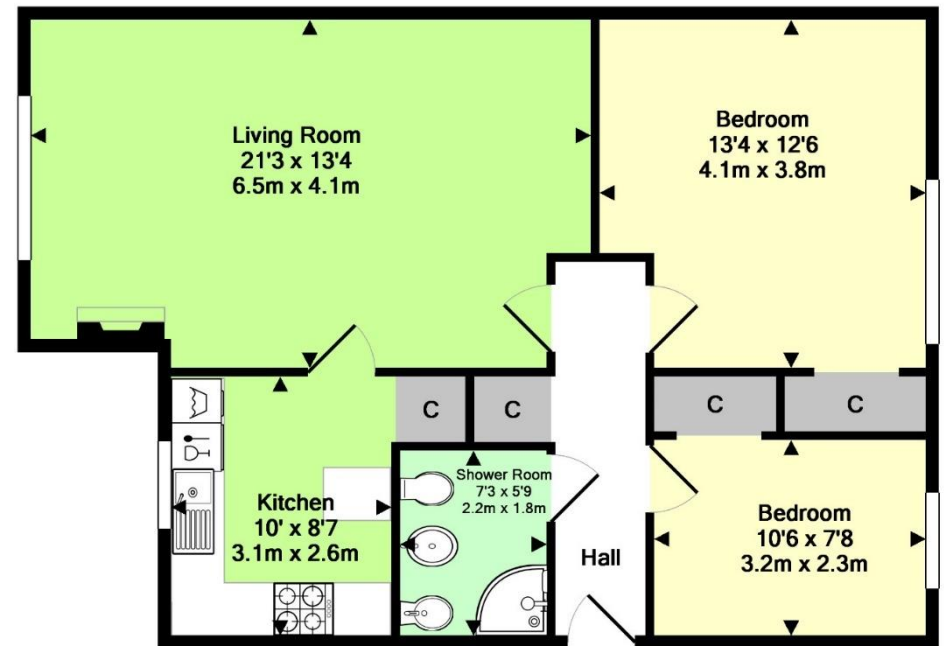

Total Approx. Floor Area 732 Sq.Ft. (68.0 Sq.M.)  
Measurements are approximate. Not to scale. Illustrative purposes only  
Made with Metropix ©2019



Michael Everett & Co. Regency House 61 Walton Street Walton On The Hill Surrey KT20 7RZ  
Tel: 01737 814877 Email: [walton@michael-everett.co.uk](mailto:walton@michael-everett.co.uk) [www.michael-everett.co.uk](http://www.michael-everett.co.uk)

**Disclaimer:** These details are for guidance only and reference to any fixtures and fittings, including photographs, does not guarantee that the said items are included in the sale. The floorplan is an illustration and is therefore for layout guidance only and is not drawn to scale, unless stated. Whilst every care is taken in the preparation of this plan, please check all dimensions and shapes before making any decisions reliant upon them.