



# MEADE COURT

WALTON ON THE HILL

# 1 MEADE COURT

WALTON STREET, WALTON ON THE HILL, KT20 7RN



1 RECEPTION ROOM



KITCHEN



2 BEDROOMS



BATHROOM & EN SUITE SHOWER ROOM

APPROX 615.53 FT<sup>2</sup> | 57.18 M<sup>2</sup> EPC RATING: C COUNCIL TAX BAND: E

UNEXPIRED LEASE 93 YEARS

Set in an attractive modern development built in 1993 by Berkeley Homes an attractive split level maisonette with its own private courtyard garden. Entrance via ground floor level.

This property features a private entrance with hallway, a good size living room with doors out onto a private part walled patio garden, a kitchen, downstairs wc, two first floor bedrooms, an en-suite shower room and a bathroom.

Outside, there are areas of well maintained communal gardens with a covered private car port and visitor parking.

The property is located right in the heart of the village with easy access to a range of shops and services, pub/restaurants, the village primary school and the picturesque Mere Pond and Church Green. The property is offered for sale with no chain.

ASKING PRICE: **£395,000** LEASEHOLD



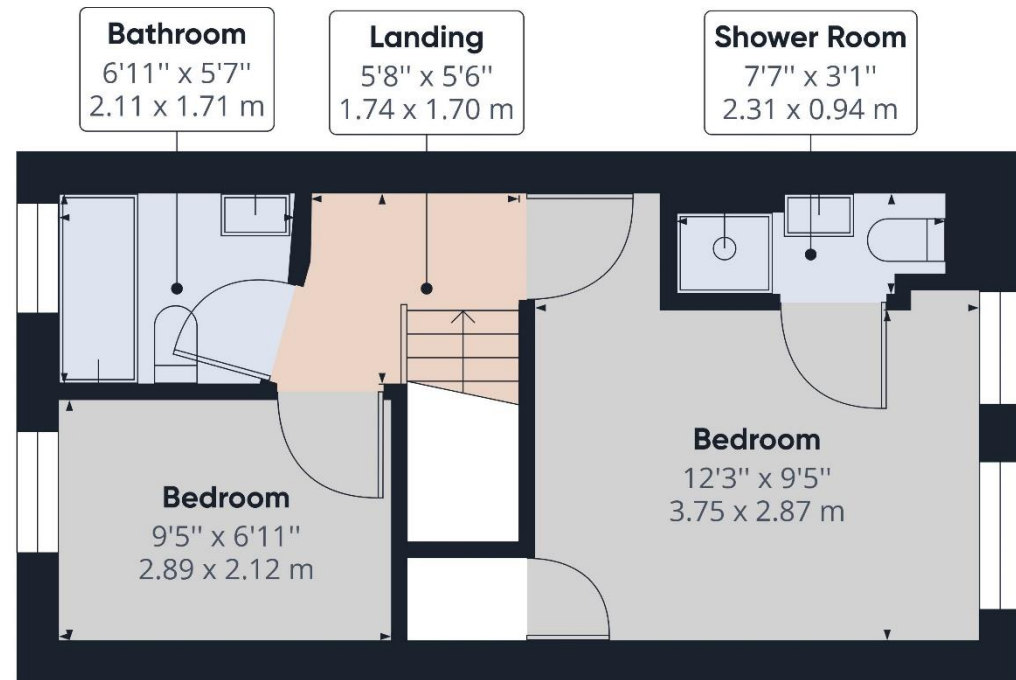
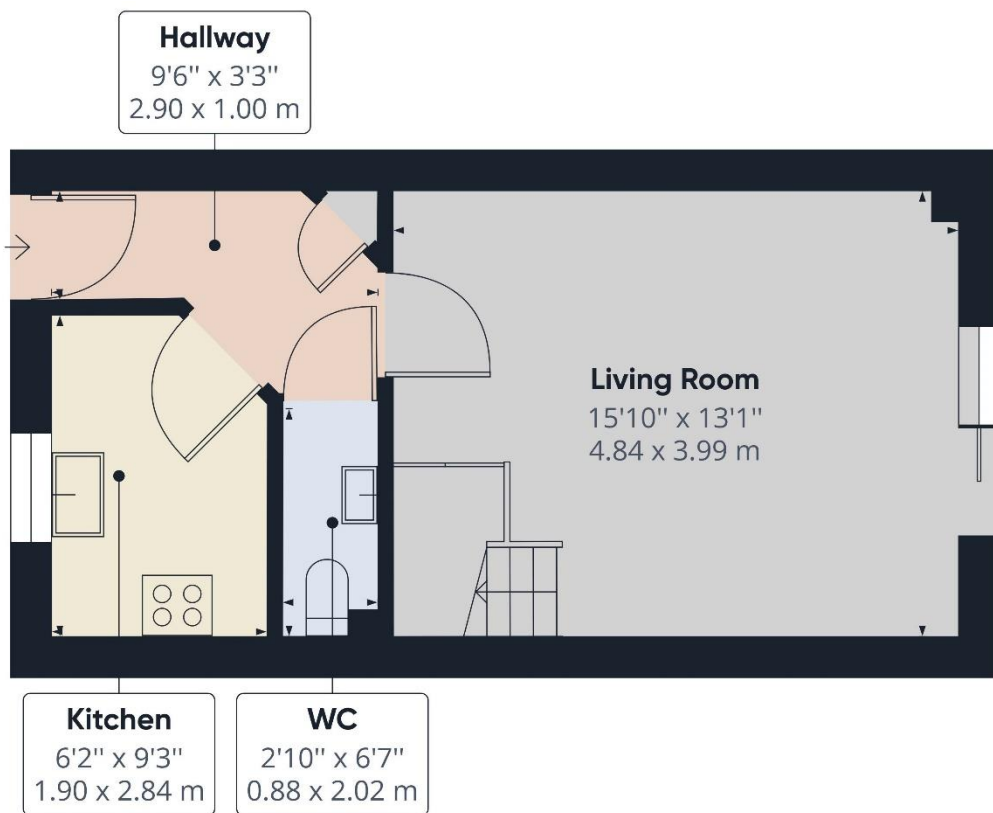



**WALTON ON THE HILL OFFICE** 61 Walton Street, Walton-on-the-Hill, Surrey KT20 7RZ  
**01737 814877**



**IMPORTANT** We would inform prospective purchasers that these sales particulars have been prepared as a general guide only. A detailed survey has not been carried out, nor the services, appliances and fittings tested. Room sizes should not be relied upon for furnishing purposes and are approximate. If floor plans are included, they are for guidance only and illustration purposes only and may not be to scale. If there are any important matters likely to affect your decision to buy, please contact us before viewing the property.

michael-everett.co.uk