



# 1 CARISBROOKE WAY

SPALDING, PE12 6DS

**£379,995**  
**FREEHOLD**

Welcome to Carisbrooke Way, a charming property located in the peaceful village of Weston Hills, Spalding. This delightful detached bungalow boasts ample space with 2 reception rooms, 4 bedrooms, and 2 bathrooms spread across its generous 1,881 sq ft.

One of the standout features of this property is the beautiful south-facing rear garden, perfect for enjoying sunny afternoons and al fresco dining. The garden is well-maintained and offers a tranquil retreat right at your doorstep.

Parking will never be an issue with space for up to 5 vehicles, along with a convenient single garage for additional storage. The property's large size provides plenty of room for comfortable living and entertaining guests.



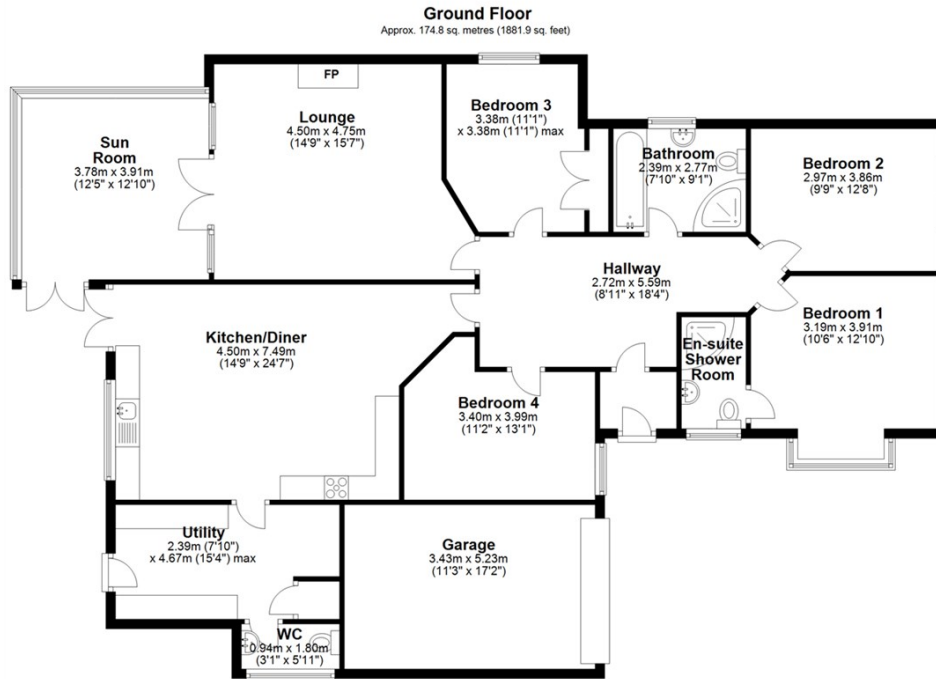

Total area: approx. 174.8 sq. metres (1881.9 sq. feet)  
**1 carrisbroke**



Energy Efficiency Rating		Current	Potential
Very energy efficient - lower running costs			
(92 plus) <b>A</b>			
(81-91) <b>B</b>			
(69-80) <b>C</b>		72	82
(55-68) <b>D</b>			
(39-54) <b>E</b>			
(21-38) <b>F</b>			
(1-20) <b>G</b>			
Not energy efficient - higher running costs			
<b>England &amp; Wales</b>		EU Directive 2002/91/EC	

Agents Note: Whilst every care has been taken to prepare these particulars, they are for guidance purposes only. All measurements are approximate and are for general guidance purposes only and whilst every care has been taken to ensure their accuracy, they should not be relied upon and potential buyers/tenants are advised to recheck the measurements

Spalding Office Sales  
11 The Crescent  
Spalding  
Lincolnshire  
PE11 1AE

01775 713 888  
enquiries@sedge-homes.com  
www.sedge-homes.com

