

ELLIOTTS

Working hard for you



66 The Priory, London Road, Patcham, BN1 8QT

£280,000 Share of Freehold

ELLIOTTS are pleased to present this newly renovated first-floor purpose-built apartment, nestled within a sought-after low-rise development. Featuring spacious, bright, and south-facing accommodation, including residents' parking and is available for immediate occupancy with no onward chain.

- Newly Modernised
- First Floor
- Communal Parking
- Newly Fitted Kitchen
- Newly Carpeted
- Feature 20'+ Living Room
- Chain Free
- South Facing
- New White Bathroom
- Share Of Freehold



www.elliottsestateagents.co.uk

2 Church Road, Hove, East Sussex, BN3 2FL

T: 01273 773399

E: mail@elliottsestateagents.co.uk

Registered No 2829245

Registered Office: 2 Church Road, Hove, East Sussex, BN3 2FL

**ELLIOTTS***Working hard for you*

Tucked away towards the rear of this highly sought-after development of smaller, low-rise blocks, this bright south-facing flat enjoys a prime position adjacent to a spacious communal garden and benefits from residents' parking. Having recently undergone a major programme of improvement and updating, the property now features a fresh, neutral white décor, a brand-new fitted kitchen, a modern white bathroom, and new flooring throughout. Additional highlights include double glazing and independent gas-fired central heating.

With approximately 75 square metres (over 800 square feet) of well-planned accommodation, all rooms are accessed via a long entrance hall. The property offers two bedrooms, both with built-in storage, a separate kitchen with a window overlooking the side communal garden, and a standout living room measuring over 20 feet in length, complete with a wide bay window perfect for a dining area. Conveniently situated just off London Road, the property provides easy access to the shopping amenities of Patcham and Preston Park. Excellent transport links offer direct routes into Brighton city centre and northwards onto the A23/A27.



2 Church Road, Hove, East Sussex, BN3 2FL

T: 01273 773399

E: mail@elliottsestateagents.co.uk

Registered No 2829245

Registered Office: 2 Church Road, Hove, East Sussex, BN3 2FL

www.elliottsestateagents.co.uk

ELLIOTTS

Working hard for you

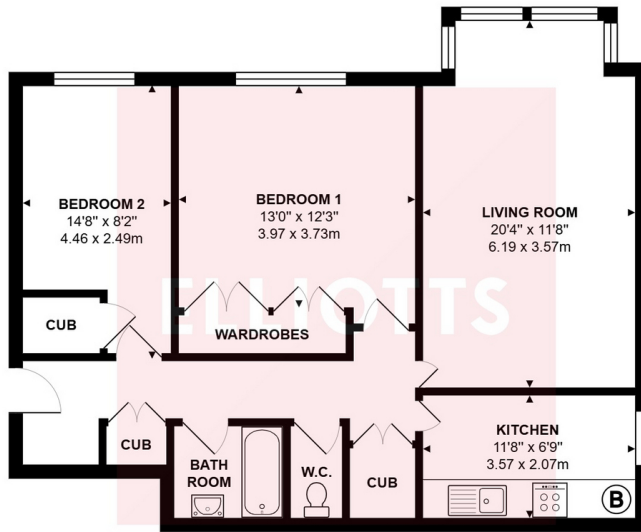

Total Area: 813 ft² ... 75.5 m²

All measurements are approximate and for display purposes only

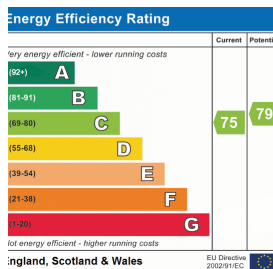

You may download, store and use the material for your own personal use and research. You may not republish, retransmit, redistribute or otherwise make the material available to any party or make the same available on any website, online service or bulletin board of your own or of any other party or make the same available in hard copy or in any other media without the website owner's express prior written consent. The website owner's copyright must remain on all reproductions of material taken from this website.

www.elliottsestateagents.co.uk

2 Church Road, Hove, East Sussex, BN3 2FL

T: 01273 773399

E: mail@elliottsestateagents.co.uk

Registered No 2829245

Registered Office: 2 Church Road, Hove, East Sussex, BN3 2FL