

ELLIOTTS

Working hard for you



111 Ashdown Eaton Road, Hove, BN3 3AR

Offers Over £250,000 Leasehold

A chance to purchase this one-bedroom 4th floor apartment enjoying South views over Hove. Features include a south-facing lounge, double bedroom, kitchen and shower room. You'll also have use of an excellent communal roof terrace located within the development.

- Fourth Floor (Lift) PB Apartment
- 69 Sq.Mt / 742 Sq.Ft
- 19' South Facing Lounge
- Superb South Views
- Kitchen Over-Looking Cricket Ground
- Double Bedroom
- Shower Room - Separate WC
- r. 999 Year Lease
- Views of Sussex Cricket Ground
- Feature Communal Roof Terrace



www.elliottsestateagents.co.uk

2 Church Road, Hove, East Sussex, BN3 2FL

T: 01273 773399

E: mail@elliottsestateagents.co.uk

Registered No 2829245

Registered Office: 2 Church Road, Hove, East Sussex, BN3 2FL



ELLIOTTS

Working hard for you



Situated on Eaton Road in Hove, this well presented apartment benefits from an excellent living space of 68Sq.Mt making it larger than most one-bedroom apartments currently for sale.

Located on the fourth floor with lift access, the apartment features a 19' South-facing lounge that provides superb views south. The kitchen overlooks part of the Sussex Cricket Ground, making it a great spot for sports enthusiasts.

The double bedroom is well-sized and also overlooks the cricket ground, and the property includes a shower room with a separate WC. The apartment benefits from the remainder of a 999-year lease, offering long-term security for potential buyers.

This apartment enjoys dual aspect views over Sussex County Cricket Ground as well as having stunning Southerly views over central Hove and toward the sea. There is also the benefit of various communal features including a superb South facing rooftop terrace, with seating, a laundry area on the ground floor and allocated parking which is available subject to an additional yearly payment and is subject to availability.



2 Church Road, Hove, East Sussex, BN3 2FL

T: 01273 773399

E: mail@elliottsestateagents.co.uk

Registered No 2829245

Registered Office: 2 Church Road, Hove, East Sussex, BN3 2FL

www.elliottsestateagents.co.uk

ELLIOTTS

Working hard for you

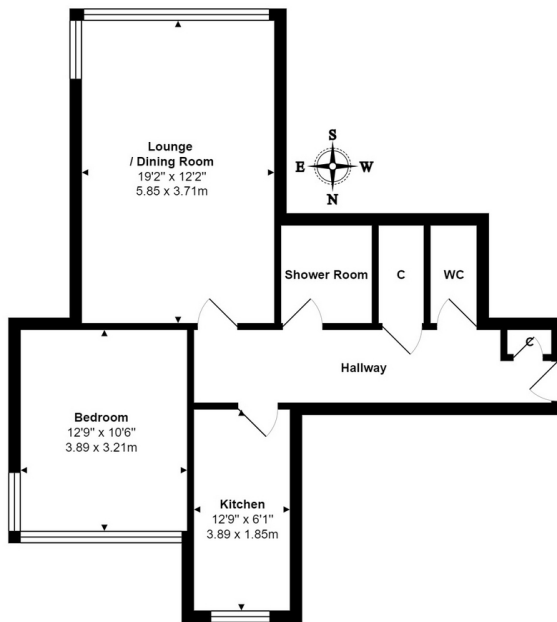

All measurements are approximate and for display purposes only

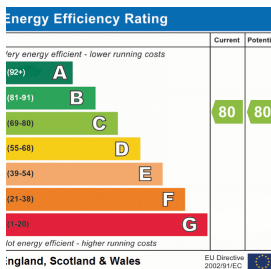

You may download, store and use the material for your own personal use and research. You may not republish, retransmit, redistribute or otherwise make the material available to any party or make the same available on any website, online service or bulletin board of your own or of any other party or make the same available in hard copy or in any other media without the website owner's express prior written consent. The website owner's copyright must remain on all reproductions of material taken from this website.

www.elliottsestateagents.co.uk

2 Church Road, Hove, East Sussex, BN3 2FL

T: 01273 773399

E: mail@elliottsestateagents.co.uk

Registered No 2829245

Registered Office: 2 Church Road, Hove, East Sussex, BN3 2FL