



Five bedroom family house within a cul-de-sac on the southern edge of Kingswood

exclusive to

SAUNDERS

richardsaunders.co.uk

Kingswood KT20

Banstead Village 5.1 miles
London by rail 45 minutes
M25 (Junction 8) 2.5 miles

All times and distances are approximate

A large five double bedroom family house within a close on the southern edge of Kingswood and conveniently positioned for excellent access to the M25 via the A217. The property offers natural light throughout and allows for spacious living with ample storage. Additional features are the in and out driveway with garage and an enclosed rear garden.



Available August

Five Bedrooms

Unfurnished

Within A Cul-De-Sac

Short Walk To Kingswood Village

Four Reception Rooms

Price £3,200pcm







GROUND FLOOR:
APPROX. FLOOR
AREA 1542 SQ.FT.
(143.3 SQ.M.)

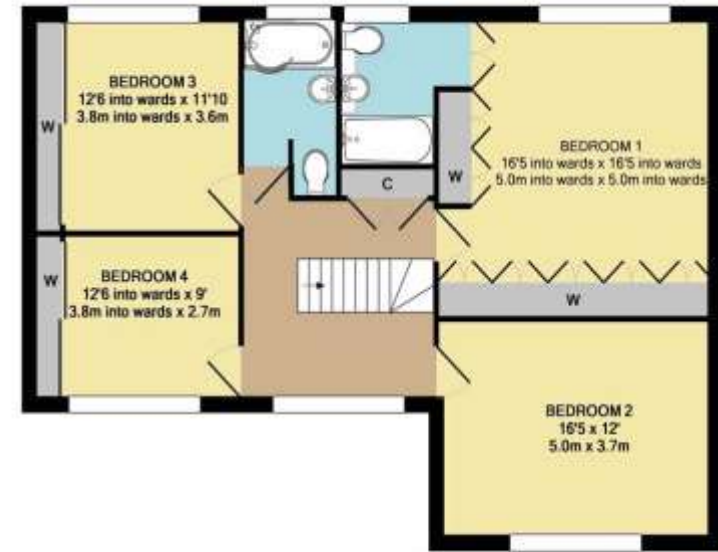

1ST FLOOR:
APPROX. FLOOR
AREA 970 SQ.FT.
(90.1 SQ.M.)

TOTAL APPROX. FLOOR AREA 2512 SQ.FT. (233.3 SQ.M.)
Made with Metaplan (2018)

FFTP Available

Gas, water, electricity, broadband and council tax utility bills are the tenants responsibility

We hold our deposits in a TDS scheme

To the best of our knowledge on production of this brochure

discover more at richardsaunders.co.uk



IMPORTANT NOTICE TO PURCHASERS: We endeavour to make our sales particulars accurate and reliable, however, they do not constitute or form part of an offer or any contract and none is to be relied upon as statements of representation or fact. The services, systems and appliances listed in this specification have not been tested by us and no guarantees as to their operating ability or efficiency are given. All measurements have been taken as guide to prospective buyers only, and are not precise. If you require clarification or further information on any points, please contact us, especially if you are travelling some distance to view.



Viewing
Please call us to arrange
a viewing appointment

1 Waterhouse Lane
Kingswood
01737 360000

2 High Street
Banstead
01737 363333

Residential Lettings
All Areas
01737 370700

