



Three bedroom semidetached home located in Coulsdon

exclusive to
SAUNDERS
richardsaunders.co.uk

Coulsdon CR5

London 16 miles Banstead Village 3 miles
London by rail 25 minutes from Coulsdon South
M23 / M25 motorways 2 miles
All times and distances are approximate

This well-presented three bedroom semi-detached house has a quiet Coulsdon location overlooking Rickman Park and is within walking distance of local shops and schools. Maintained to a good standard this house is beautifully presented with bright and spacious rooms. The sunning rear enclosed garden is a key feature of the property. The M5 & M23 are close by providing access to both Gatwick and Heathrow airports. Commuters by train can use either Chipstead or Coulsdon which offer links direct into London.



- Available January
- Three Bedrooms
- Driveway Parking For Multiple Cars
- Modern Family Bathroom
- Over Looking Rickman Hill Recreation Park
- Stunning Rear Garden

Price £2,150pcm







GROUND FLOOR
APPROX. FLOOR
AREA 551 SQ.FT.
(51.2 SQ.M.)

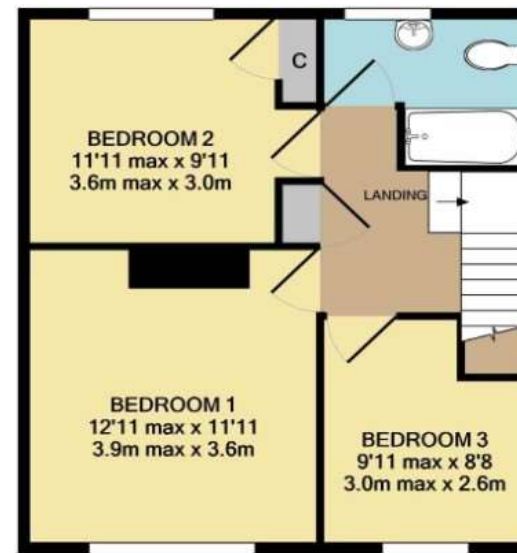

1ST FLOOR
APPROX. FLOOR
AREA 458 SQ.FT.
(42.5 SQ.M.)

TOTAL APPROX. FLOOR AREA 1009 SQ.FT. (93.8 SQ.M.)
Made with Metropix ©2021



discover more at richardsaunders.co.uk



IMPORTANT NOTICE TO PURCHASERS: We endeavour to make our sales particulars accurate and reliable, however, they do not constitute or form part of an offer or any contract and none is to be relied upon as statements of representation or fact. The services, systems and appliances listed in this specification have not been tested by us and no guarantees as to their operating ability or efficiency are given. All measurements have been taken as guide to prospective buyers only, and are not precise. If you require clarification or further information on any points, please contact us, especially if you are travelling some distance to view.

Viewing
Please call us to arrange
a viewing appointment

1 Waterhouse Lane
Kingswood
01737 360000

2 High Street
Banstead
01737 363333

Residential Lettings
All Areas
01737 370700

