



5 Westland Road, Cottesmore, LE15 7DS

£185,000

Shouler & Son
Land & Estate Agents, Valuers & Auctioneers

5 Westland Road Cottesmore LE15 7DS

A fantastic opportunity to acquire this THREE bedroom mid terrace property in need of cosmetic updating internally located in the sought after village of Cottesmore in the county of Rutland.

The property benefits from a modern gas fired boiler located in the attic space and aluminium double glazing with secondary glazing.

The property comprises of porch, entrance hall, large sitting room, kitchen, three bedrooms, shower room, WC and a garden to the rear.

Cottesmore is a well serviced village with many local amenities and is located within a 4 mile drive from both Oakham and Rutland Water.





Bedroom



Bathroom

SUMMARY

PORCH : with double glazing, tiled floor and secondary door to entrance hall.

ENTRANCE HALL : with stairs to first floor landing and radiator.

KITCHEN : a fitted kitchen with a range of eye and base level units, laminate worktops, stainless steel sink, space for fridge freezer and washing machine, door to back garden, space for oven, tiled flooring, and tiled splashbacks.

SITTING ROOM : a spacious room with sliding patio door to garden.

LANDING : with loft hatch.

BEDROOM ONE : a double bedroom with radiator.

BEDROOM TWO : a double bedroom with radiator.

BEDROOM THREE : a single bedroom with storage cupboard and radiator.

SHOWER ROOM : with shower enclosure and sink.

WC : with low flush WC.

GARDEN : a rear garden with small patio area, mainly laid to lawn with several brick built outhouse storage and rear access.

IMPORTANT INFORMATION

Council Tax: Rutland Council Band B.

Services: Main gas, electric, water and drainage.

Internet: ADSL and Fibre available.

EPC: Band C.

FREEHOLD: Vacant possession upon completion.

NO ONWARD CHAIN.

DISCLAIMER

We produce property particulars in good faith and believe them to be correct. We generally rely on what we are told without obtaining proof. You should verify for yourself such information before entering into a contract to take this property. Neither Shouler & Son nor their clients guarantee accuracy of the particulars, and they are not intended to form any part of a contract. No person in the employment of Shouler & Son has authority to give any representation or warranty in respect of this property.

Ground Floor

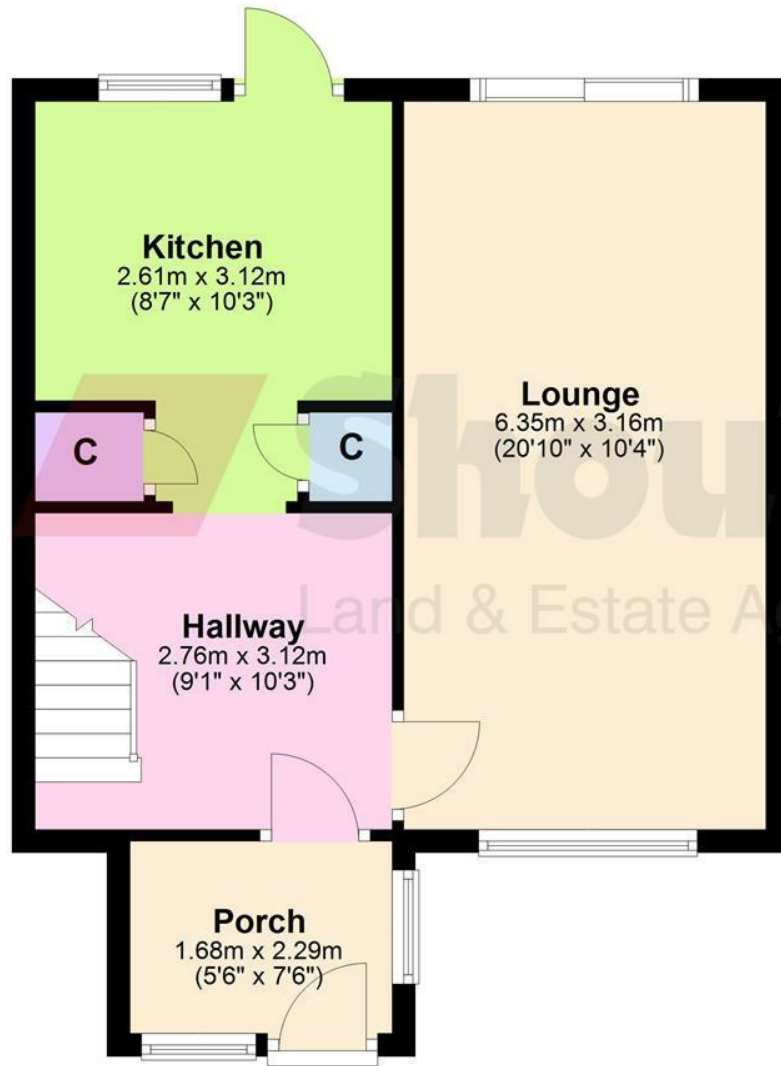

First Floor



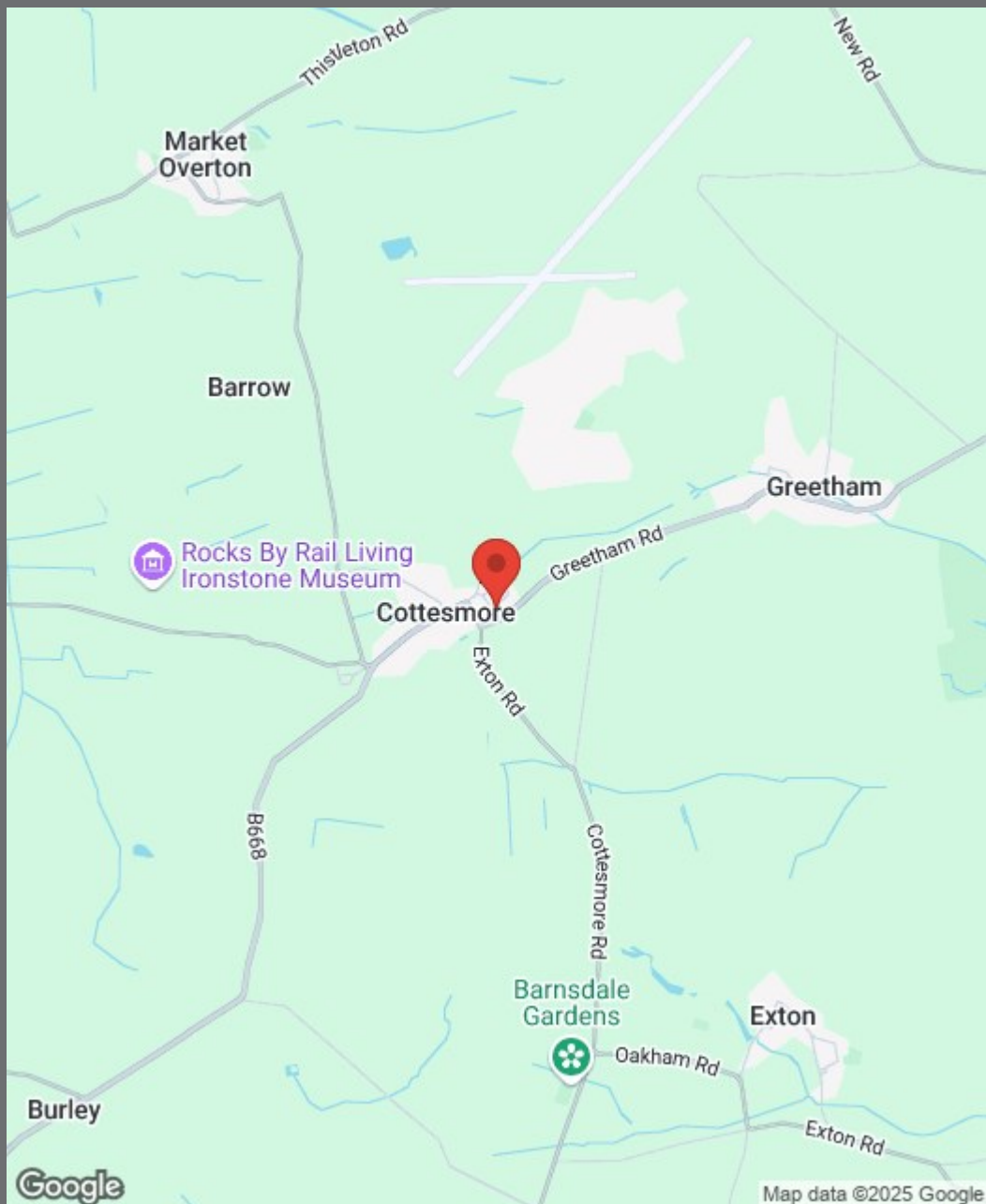

- MID TERRACE PROPERTY
- IN NEED OF COSMETIC UPDATED INTERNALLY
- THREE BEDROOMS
- ON STREET PARKING
- ALUMINUM DOUBLE GLAZING
- MODERN GAS FIRED BOILER
- REAR GARDEN
- LARGE SITTING ROOM
- SOUGHT AFTER VILLAGE
- NO UPWARD CHAIN



salary.flushes.yourself



County Chambers, Kings Road,
Melton Mowbray, Leicestershire LE13 1QF

www.shoulers.co.uk
salesenquiries@shoulers.co.uk

Tel: 01664 560181

 **Shouler & Son**
Land & Estate Agents, Valuers & Auctioneers

We produce property particulars in good faith and believe them to be correct. We generally rely on what we are told without obtaining proof. You should verify for yourself such information before entering into a contract to take this property. Neither Shouler & Son nor their clients guarantee accuracy of the particulars, and they are not intended to form any part of a contract. No person in the employment of Shouler & Son has authority to give any representation or warranty in respect of this property.