



21 The Crescent, Melton Mowbray, LE13 0NF
£250,000

 **Shouler & Son**
Land & Estate Agents, Valuers & Auctioneers

21 The Crescent Melton Mowbray LE13 0NF



Living Room

This semi-detached house presents an excellent opportunity for those looking to settle in a picturesque part of Melton Mowbray. With its charming features and convenient location, it is sure to appeal to a wide range of buyers. Do not miss the chance to make this lovely house your new home.



Kitchen



Sun Room



Garden

Description

This traditional three-bedroom semi-detached home is situated on the ever-popular Crescent in Melton Mowbray, offering a wonderful opportunity for those seeking a well-positioned property full of potential. Set back from the road, the property is approached via a pathway leading to the front entrance door, which opens into a welcoming reception hallway.

The ground floor accommodation is well laid out, beginning with a comfortable living room that provides a cosy space to relax and unwind. Towards the rear of the property, the kitchen offers a practical layout with access through to a bright and airy sun room—an ideal spot to enjoy views over the garden throughout the seasons. Adjacent to the kitchen is a separate utility area that adds extra convenience and storage, along with a downstairs bathroom completing the ground floor layout.

Upstairs, the first floor offers three good-sized bedrooms, each providing space for family living, guests, or even a home office setup. The layout makes excellent use of space and provides flexibility for a range of needs.

To the rear, the property enjoys a spacious and well-maintained garden, with a generous patio area perfect for outdoor dining or entertaining, as well as a lawn bordered by mature shrubs and planting. It's a peaceful and private setting, ideal for both families and keen gardeners alike.

Located just a short walk from the town centre, local schools, parks, and transport links, this well-maintained and characterful home is ideal for families and professionals alike seeking a traditional home in a prime location.



Bedroom



Bathroom



Bedroom



Patio off the Sun Room

Ground Floor

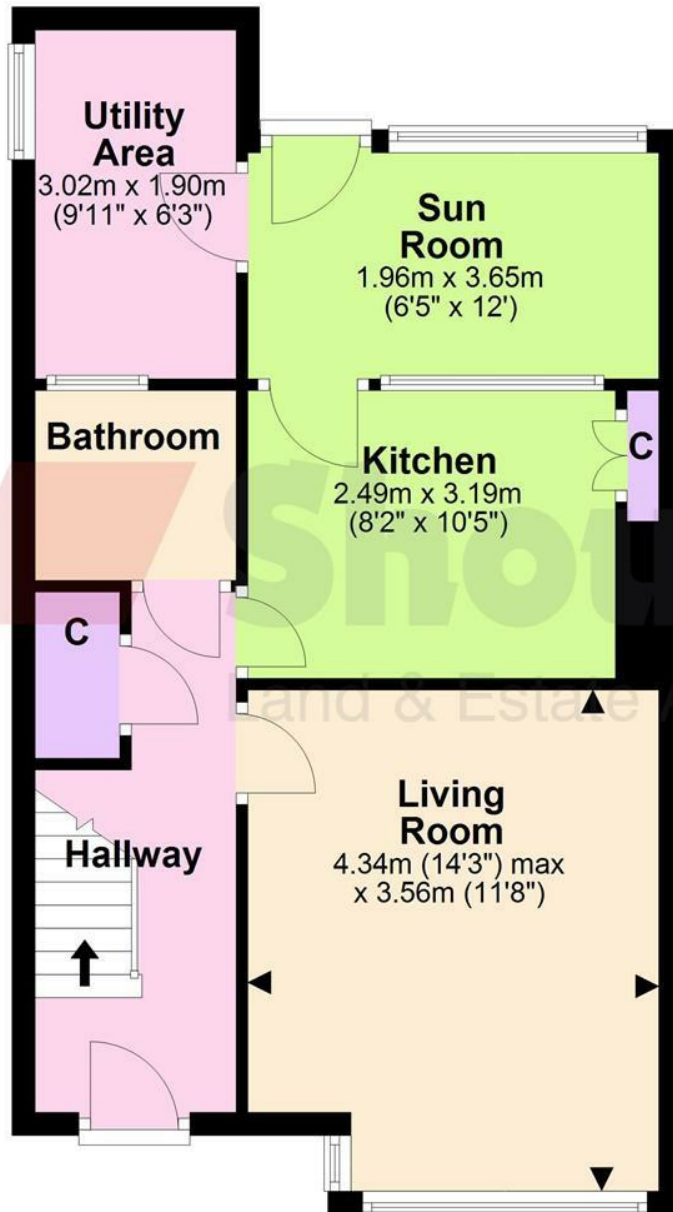

First Floor

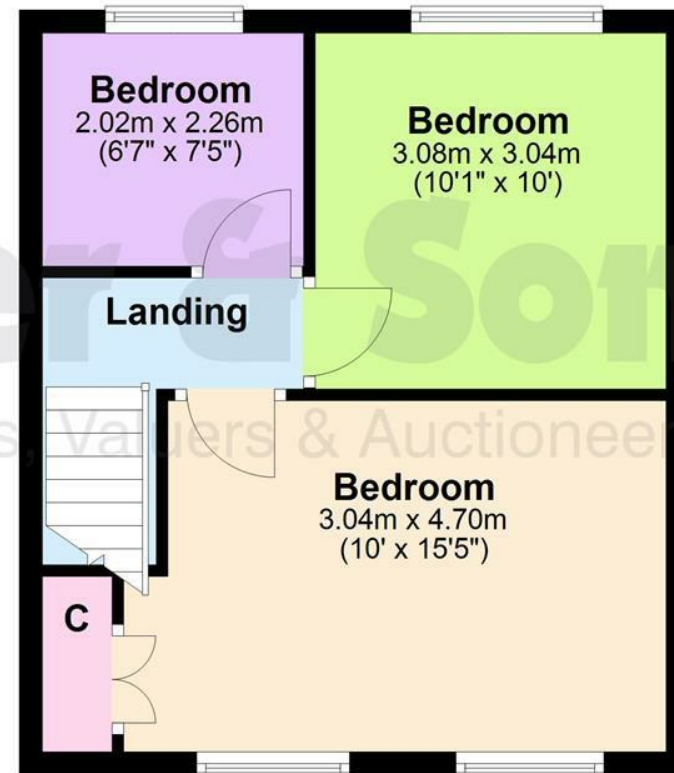

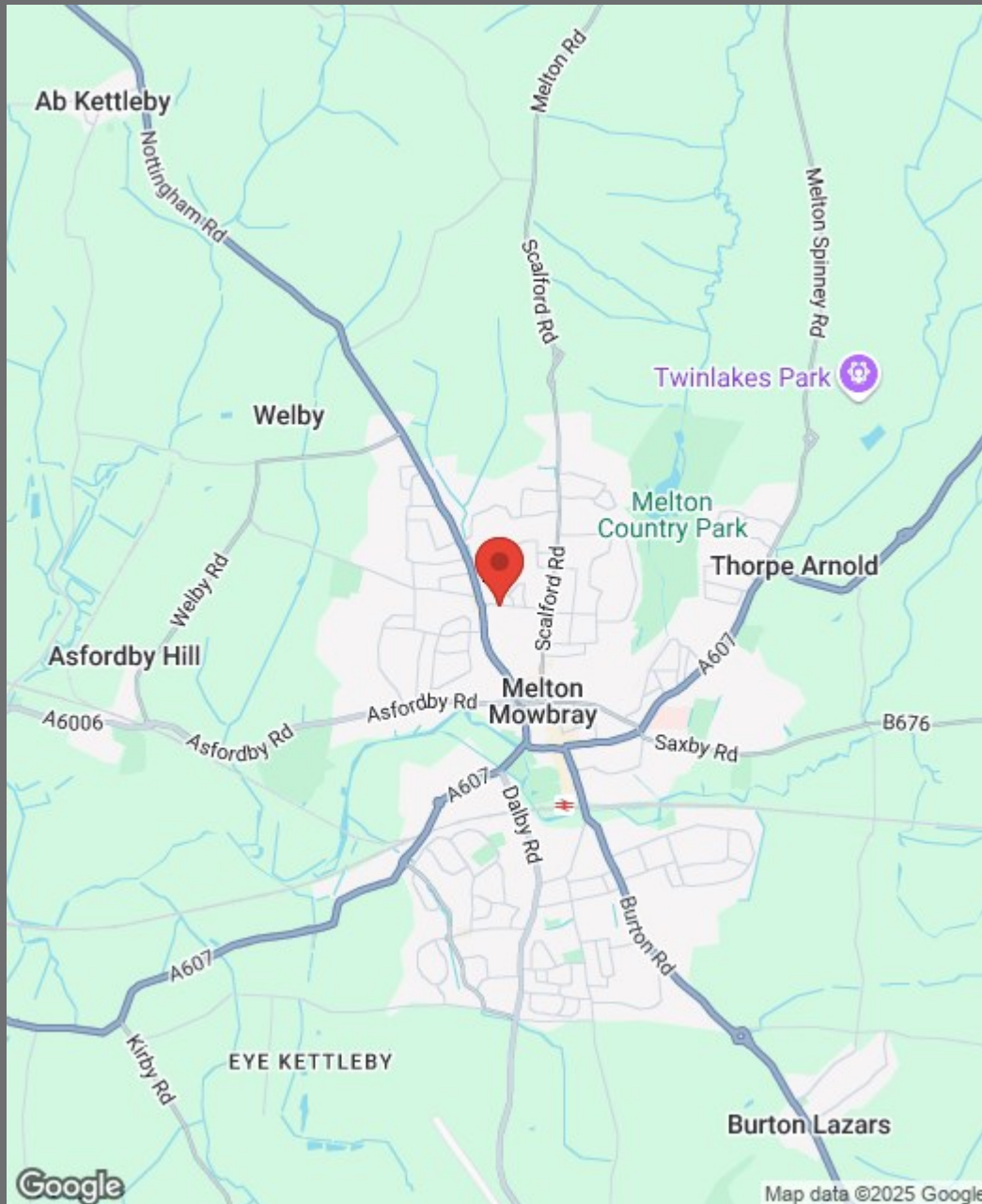

Patio

- Popular location
- Traditional semi-detached family home
- Bright sun room addition
- Convenient utility area
- Ground floor bathroom
- Three good-sized bedrooms
- Spacious rear garden
- Mature planting/patio
- Short walk to town
- Excellent potential



cages.sheets.tracks



County Chambers, Kings Road,
Melton Mowbray, Leicestershire LE13 1QF

www.shoulers.co.uk
salesenquiries@shoulers.co.uk

Tel: 01664 560181

Land & Estate Agents, Valuers & Auctioneers

We produce property particulars in good faith and believe them to be correct. We generally rely on what we are told without obtaining proof. You should verify for yourself such information before entering into a contract to take this property. Neither Shouler & Son nor their clients guarantee accuracy of the particulars, and they are not intended to form any part of a contract. No person in the employment of Shouler & Son has authority to give any representation or warranty in respect of this property.