



**4 Rookery Lane, Wymondham, LE14 2AU**  
**£1,250,000**

**Shouler & Son**  
Land & Estate Agents, Valuers & Auctioneers

# 4 Rookery Lane Wymondham LE14 2AU

---

Welcome to this charming property located on Rookery Lane in the picturesque village of Wymondham. This stunning detached house, dating back to the early 1800's, exudes character and history, perfect for those who appreciate a touch of the past. Book a viewing today and step into a world of timeless elegance and comfort.





## Description

Nestled on the fringes of the picturesque village of Wymondham, this charming, detached family home dates to the early 1800's and is an enchanting blend of historic character and modern versatility. With five generously sized bedrooms and ample living space, this residence is perfect for a growing family seeking both comfort and functionality.

Upon entering, you are greeted by an inviting atmosphere that effortlessly combines period features with contemporary updates. The expansive living areas include a welcoming living room, a formal dining room, and a bright, airy kitchen with access to a sunroom, all designed to capture natural light and provide a warm and cozy environment. In addition, there is a superb family room with two sets of external French doors. The flexible layout allows for creative use of space, making it ideal for family gatherings, entertaining guests, or enjoying quiet evenings at home.

The kitchen is designed to impress with its blend of functionality and style. Stepping into this space, you're greeted by an expansive layout that caters to both the avid home cook and those who love to entertain. It is adorned with sleek, granite work surface units that provide ample space for meal preparation. These surfaces are both practical and aesthetically pleasing, offering a seamless blend of durability and elegance. The cabinetry offers generous storage solutions, ensuring that everything from cookware to pantry items has its place, keeping the kitchen uncluttered and efficient. A stunning Oil-fired Aga, the true focal point of the room. At the centre of the kitchen is a magnificent island. This island not only enhances the workspace but also serves as a versatile hub for socializing and casual dining. With its expansive surface, it's perfect for preparing meals, while underneath the island is complemented by modern appliances seamlessly integrated into the design, ensuring that every culinary need is met with ease. Additional storage cabinets and shelves are thoughtfully integrated, maximizing functionality without compromising on style. There is a pantry under the stairs with ample storage space. Overall, this kitchen is a harmonious blend of practicality and sophistication, designed to cater to the demands of modern living while providing a beautiful space that invites creativity and connection. A separate utility room complements the kitchen perfectly.

Ascending to the first floor, you'll find an arrangement of five beautifully appointed bedrooms, each offering a unique retreat for rest and relaxation. The principal suite is a spacious bedroom that could accommodate a king-sized bed and other furniture. Three windows bathe the room in natural light, creating

a serene and inviting ambiance. The adjoining ensuite shower room is a private sanctuary, complete with a walk-in shower, a double vanity, and modern fixtures for your comfort. The second bedroom is also generously sized, providing ample space for furniture. This room is perfect for guests or family members, offering comfort and tranquillity with plenty of natural light. The third bedroom, cozy yet spacious, offers a serene environment, ideal for a child's room or a home office while the fourth bedroom, is suitable for various uses, from a guest room to a teenager's bedroom. The fifth bedroom, slightly smaller but equally charming, is perfect for a nursery, a cozy guest room, or a personal study.

A standout feature of this home is the self-contained annex, which offers endless possibilities. Whether you need accommodation for multigenerational living, a private guest suite, or potential rental income, the annex provides privacy and independence remaining separate from the main residence. The property's historic charm is evident throughout, with traditional fireplaces, and classic architectural details that exude character and warmth. The spacious garden is a true highlight, offering a serene outdoor retreat with mature trees and well-maintained landscaping. This generous outdoor space is perfect for entertaining, gardening, or simply enjoying the peaceful surroundings. There is also access to a paddock which is included in the sale of the property.

Located in the serene village of Wymondham, this home offers the tranquillity of village life while providing easy access to local amenities, schools, and transport links. The surrounding countryside adds to the picturesque setting, offering opportunities for outdoor activities and a relaxed lifestyle.

This enchanting home in Wymondham is a rare find, seamlessly blending the charm of yesteryear with the conveniences of modern living. Whether you are looking for a spacious family home or a property with flexible living arrangements, this residence is sure to meet your needs and exceed your expectations. Experience the timeless appeal of this exceptional home by scheduling a viewing today.





Sitting Room



Dining Room



Kitchen



Family Room



Principle Bedroom



Bedroom



Bedroom



Bathroom

**4 Rookery Lane, Wymondham**  
**Approximate Gross Internal Area**  
**Main House = 297 sq.m/3201 sq.ft**  
**Annex = 26 sq.m/277 sq.ft**  
**Garage = 26 sq.m/280 sq.ft**  
**Total = 349 sq.m/3758 sq.ft**

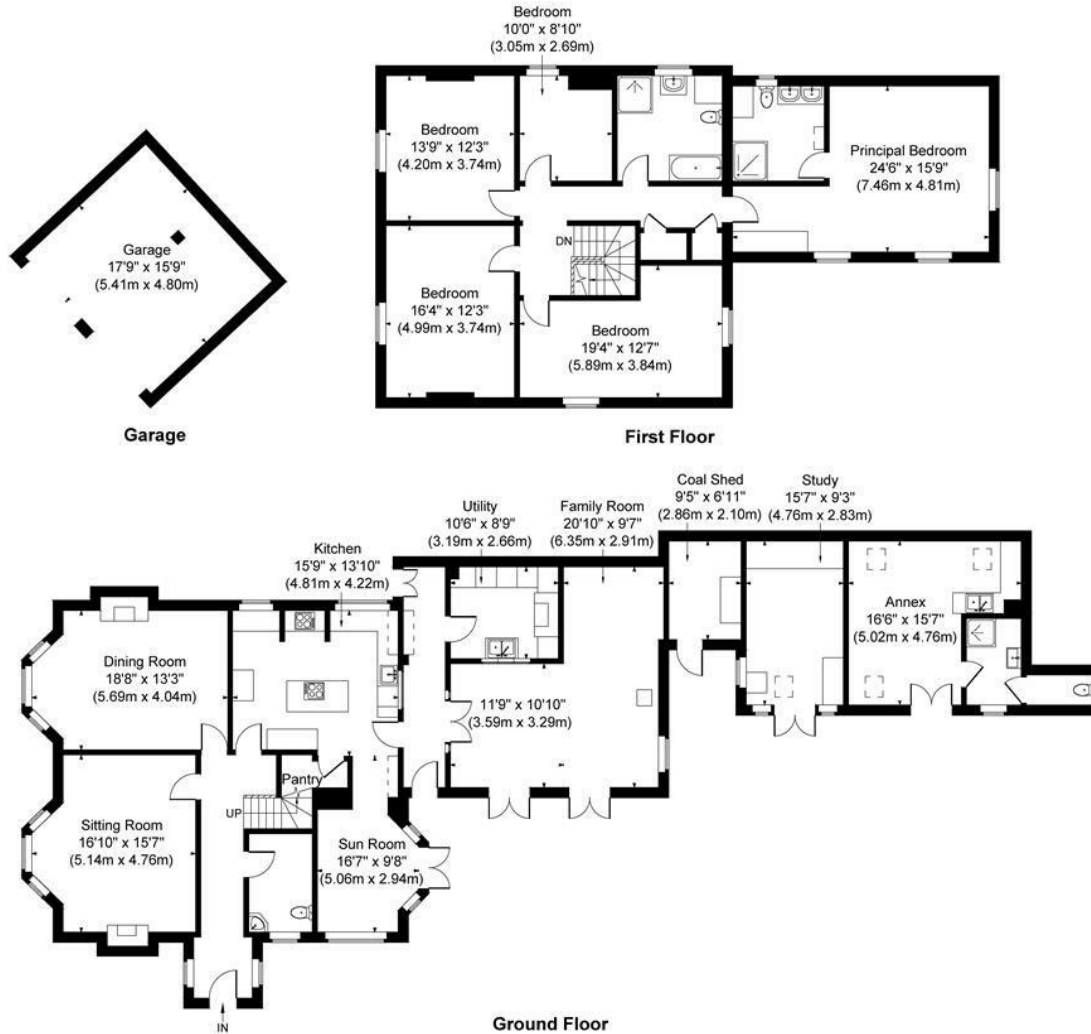
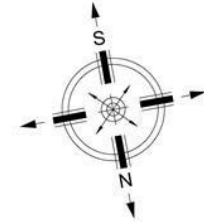

Illustration for identification purposes only, measurements are approximate, not to scale.

JonHolmesPhotography © 2024



© Crown copyright and database rights 2024. OS AC0000813445

**Promap**  
LANDMARK INFORMATION

© Crown Copyright and database rights 2024. OS AC0000813445  
Plotted Scale - 1:1250. Paper Size - A4



Google

Map data ©2024 Imagery ©2024 Maxar Technologies





Annex Bedroom/Sitting Room



Annex Kitchen

- Character Family Home
- Versatile Spacious Living Accommodation
- Separate Self Contained Annex
- Five Bedrooms
- Large Gardens
- Separate Paddock
- Driveway Parking & Garage
- Open Views



View over looking the paddocks



County Chambers, Kings Road,  
Melton Mowbray, Leicestershire LE13 1QF

Tel: 01664 560181

[www.shoulers.co.uk](http://www.shoulers.co.uk)  
[housesales@shoulers.co.uk](mailto:housesales@shoulers.co.uk)  
[lettings@shoulers.co.uk](mailto:lettings@shoulers.co.uk)

 **Shouler & Son**  
Land & Estate Agents, Valuers & Auctioneers

We produce property particulars in good faith and believe them to be correct. We generally rely on what we are told without obtaining proof. You should verify for yourself such information before entering into a contract to take this property. Neither Shouler & Son nor their clients guarantee accuracy of the particulars, and they are not intended to form any part of a contract. No person in the employment of Shouler & Son has authority to give any representation or warranty in respect of this property.