



**The Old Post Office, 29 Main Street, Goadby
Marwood, LE14 4LN
Guide Price £625,000**

The Old Post Office
29 Main Street
Goadby Marwood
LE14 4LN

Welcome to this charming detached cottage, located in the picturesque village of Goadby Marwood. This property boasts a generous living space, perfect for a growing family or those who love to entertain.





Description

Nestled in a peaceful countryside location, this charming home is perfect for those who enjoy country living and picturesque walks through the rolling landscape. Set in a quintessential English village, it offers a true escape from the hustle and bustle of city life.

Stepping inside, you are welcomed by two characterful reception rooms, each offering a cosy and inviting space for relaxation and entertaining. The home's rich history dates back to the 1600s, adding a wonderful sense of heritage and charm. The superb kitchen/dining room is well-appointed with modern appliances and provides ample space for dining, while a separate utility room enhances practicality. Thoughtfully extended to accommodate today's modern lifestyle, the property also features a study area, ideal for those working from home.

With four well-proportioned bedrooms and two bathrooms, the house provides generous space for comfort and privacy. The bright and airy bedrooms offer a peaceful retreat at the end of the day.

Surrounded by stunning countryside, this idyllic home is perfect for nature lovers, with endless opportunities for scenic walks and outdoor exploration



Sitting Room



Breakfast Kitchen



Dining Area



Family Room



Main Bedroom



Bedroom Three



Bedroom Two



Bathroom

29 Main Street, Goadby Marwood
Approximate Gross Internal Area
Main House = 158 sq.m/1701 sq.ft
Outbuilding = 36 sq.m/390 sq.ft
Total = 194 sq.m/2091 sq.ft

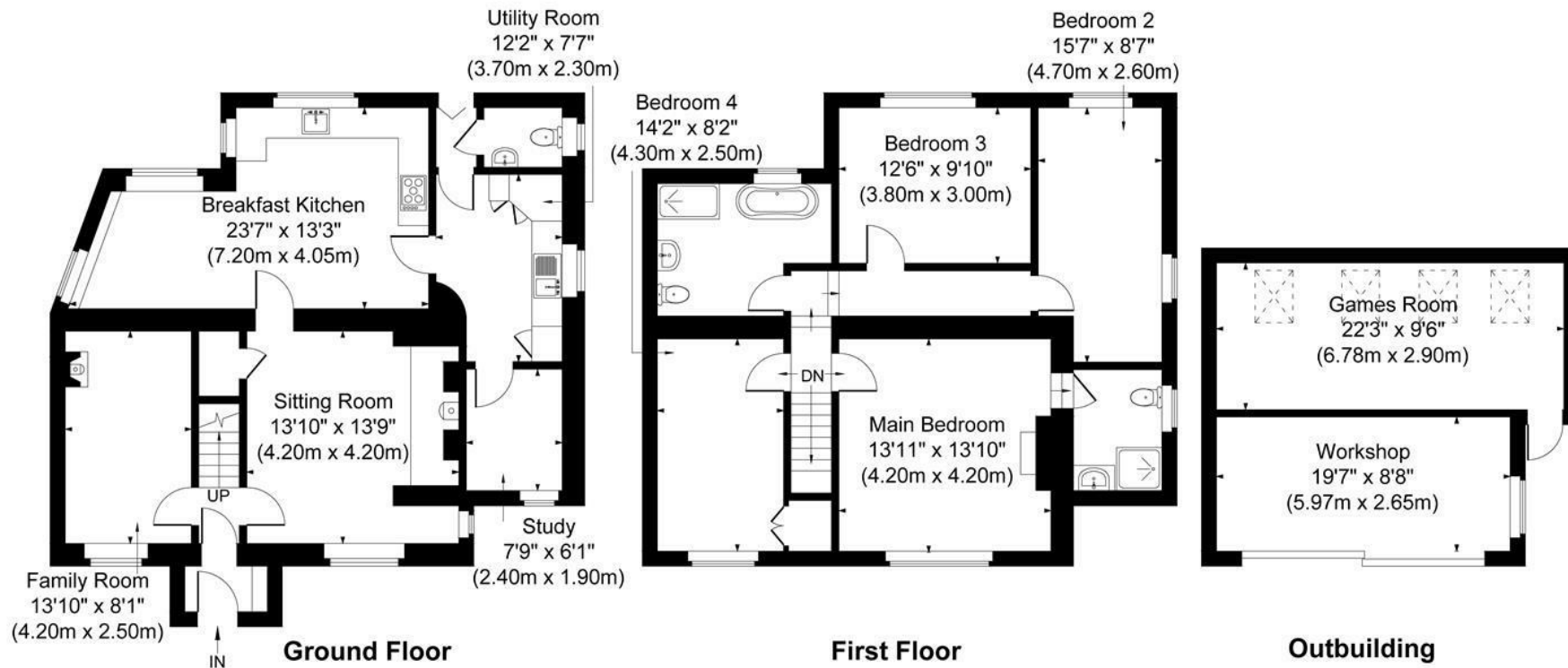
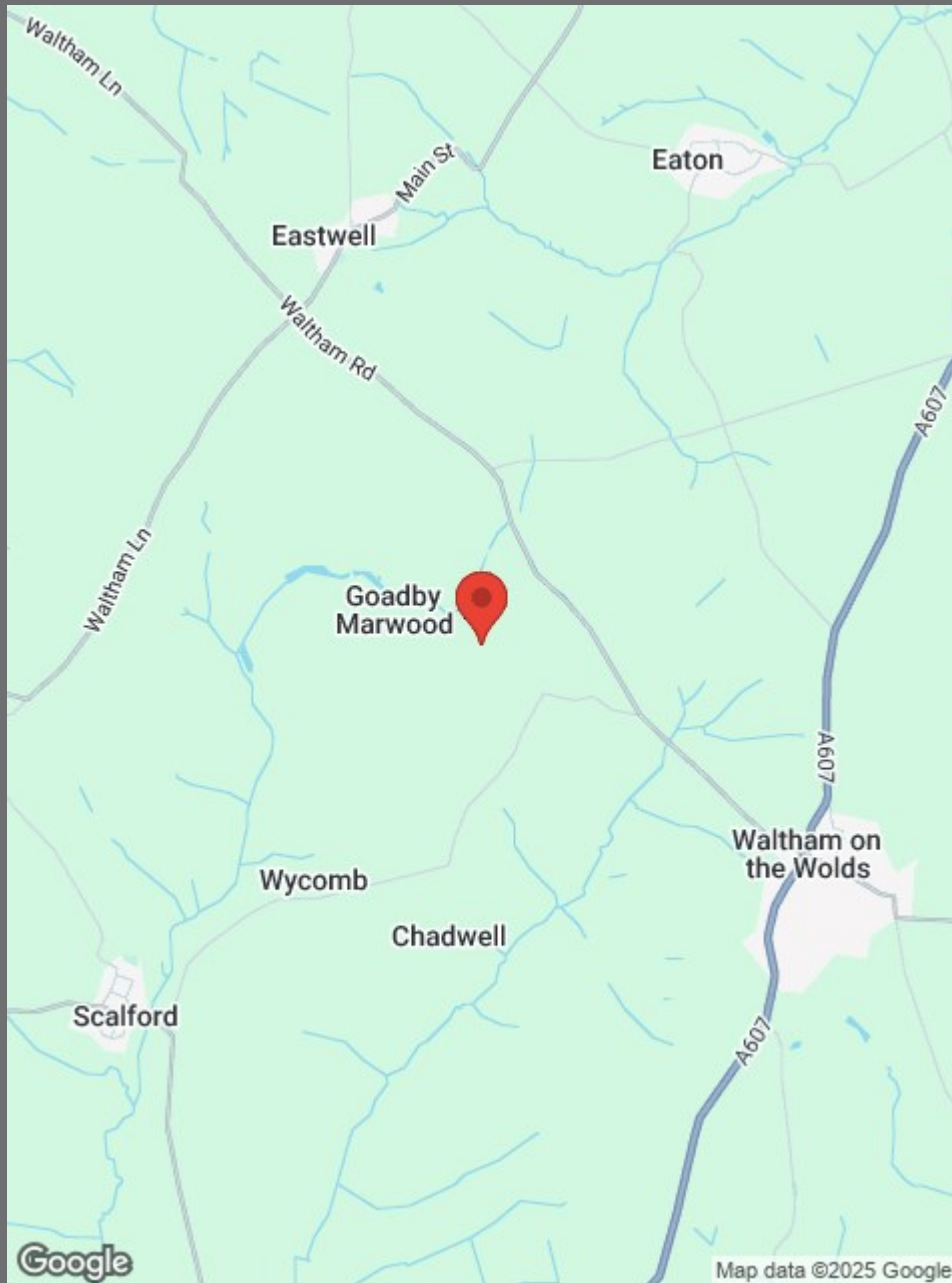

Illustration for identification purposes only, measurements are approximate, not to scale.
JonHolmesPhotography © 2024





- Detached Cottage Village Location
- Four Bedrooms
- Spacious Living Room
- Kitchen / Dining Family Room
- Driveway Parking
- Enclosed Gardens
- Inglenook Fireplace
- No Chain Sale





County Chambers, Kings Road,
Melton Mowbray, Leicestershire LE13 1QF

Tel: 01664 560181

www.shoulers.co.uk
housesales@shoulers.co.uk
lettings@shoulers.co.uk

 **Shouler & Son**
Land & Estate Agents, Valuers & Auctioneers

We produce property particulars in good faith and believe them to be correct. We generally rely on what we are told without obtaining proof. You should verify for yourself such information before entering into a contract to take this property. Neither Shouler & Son nor their clients guarantee accuracy of the particulars, and they are not intended to form any part of a contract. No person in the employment of Shouler & Son has authority to give any representation or warranty in respect of this property.