



**The Old Post Office, 29 Main Street, Goadby
Marwood, LE14 4LN
Guide Price £675,000**

Shouler & Son
Land & Estate Agents, Valuers & Auctioneers

The Old Post Office
29 Main Street
Goadby Marwood
LE14 4LN

Welcome to this charming detached cottage, located in the picturesque village of Goadby Marwood. This property boasts a generous living space, perfect for a growing family or those who love to entertain.





Description

As you step inside, you are greeted by two inviting reception rooms that offer ample space for relaxation and social gatherings. The classic design of the house, dating back to 1850, adds character and a sense of history to the property. There is a superb Kitchen / dining room, fitted with appliances and ample space for table and chairs, and a separate utility room which compliments the kitchen perfectly. The property has also been extended to suit today's modern family and for those that work at home there is a study area.

With four bedrooms and two bathrooms, there is plenty of room for everyone to enjoy their own space and privacy. The bedrooms are spacious and bright, providing a peaceful retreat at the end of the day.

Situated in a tranquil village setting, this house offers an escape from the hustle and bustle of city life. The surrounding area is known for its natural beauty and offers plenty of opportunities for outdoor activities and exploration.



Sitting Room



Breakfast Kitchen



Dining Area



Family Room



Main Bedroom



Bedroom Three



Bedroom Two



Bathroom

29 Main Street, Goadby Marwood
Approximate Gross Internal Area
Main House = 158 sq.m/1701 sq.ft
Outbuilding = 36 sq.m/390 sq.ft
Total = 194 sq.m/2091 sq.ft

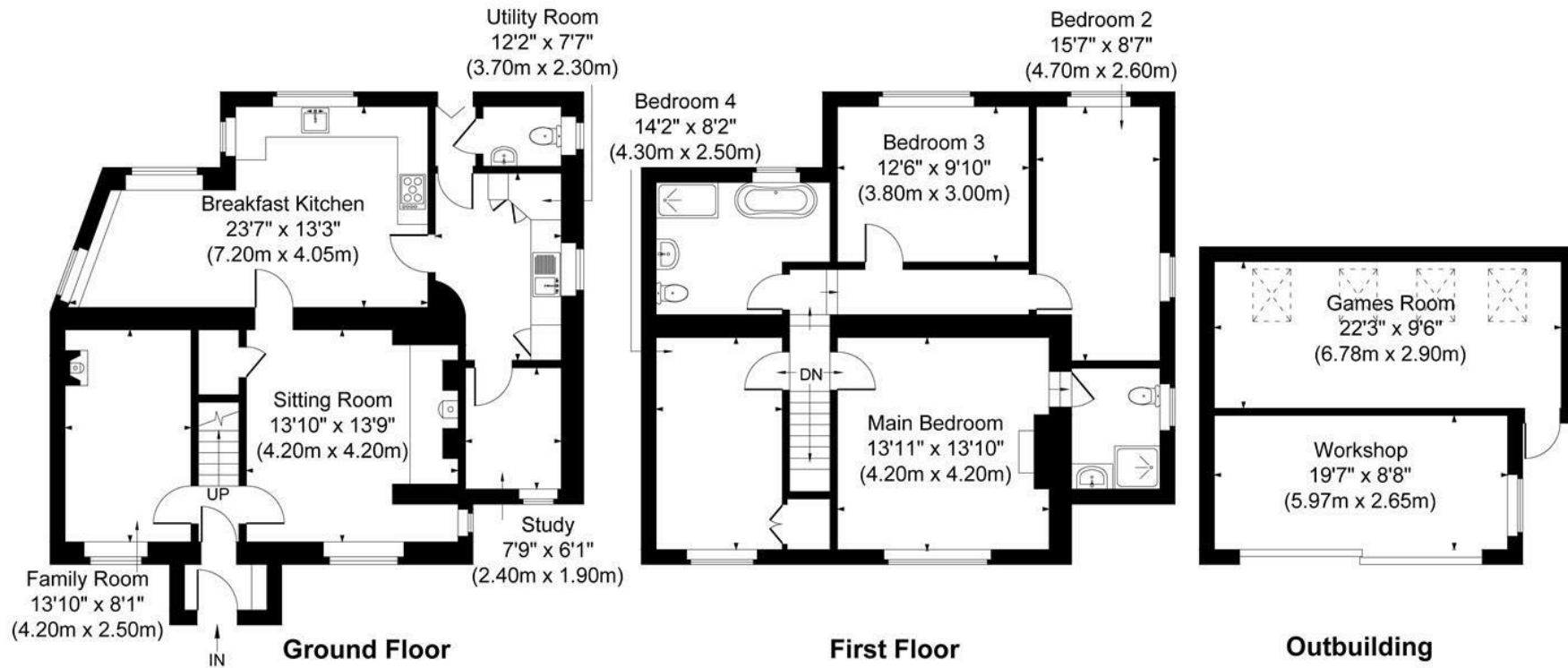
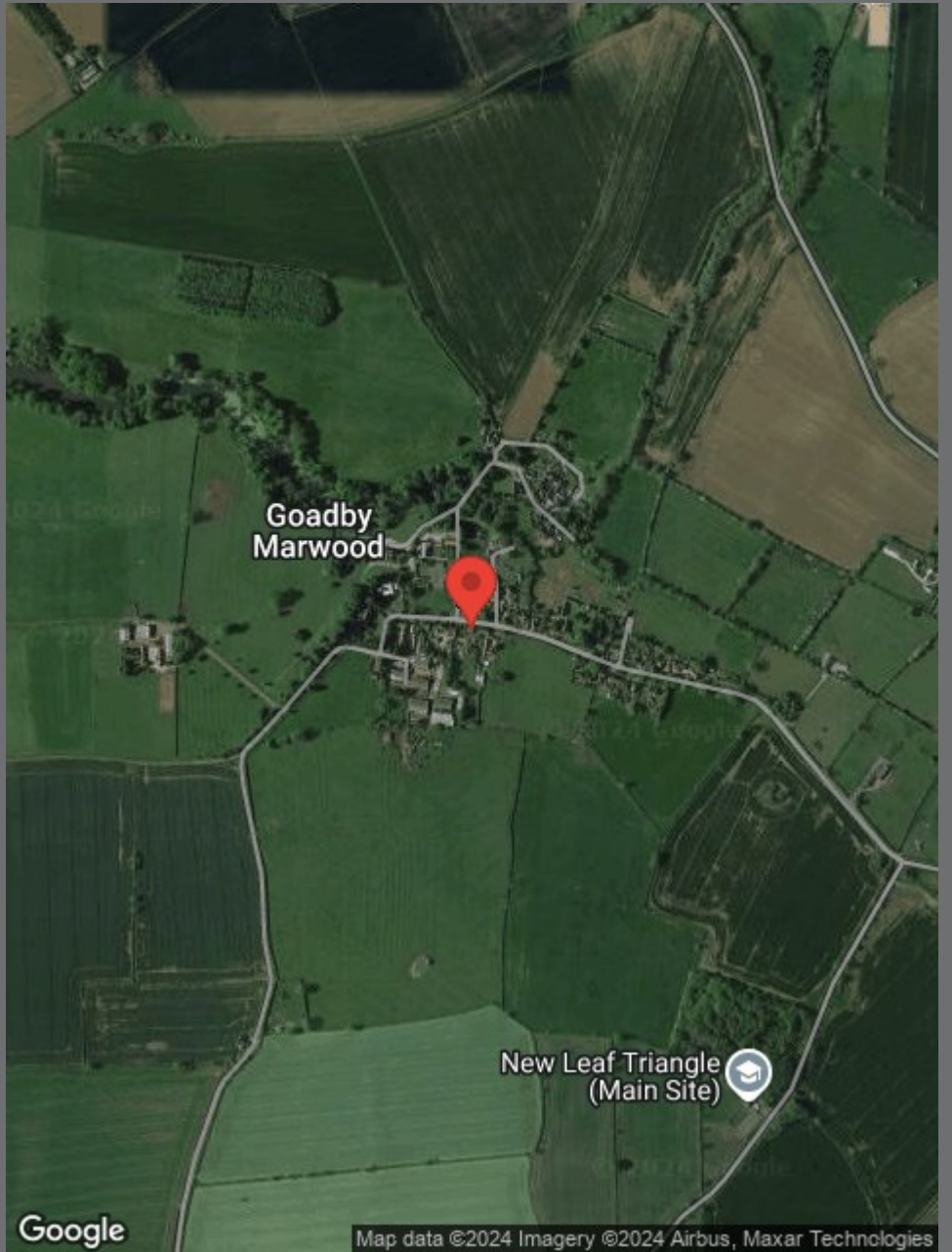
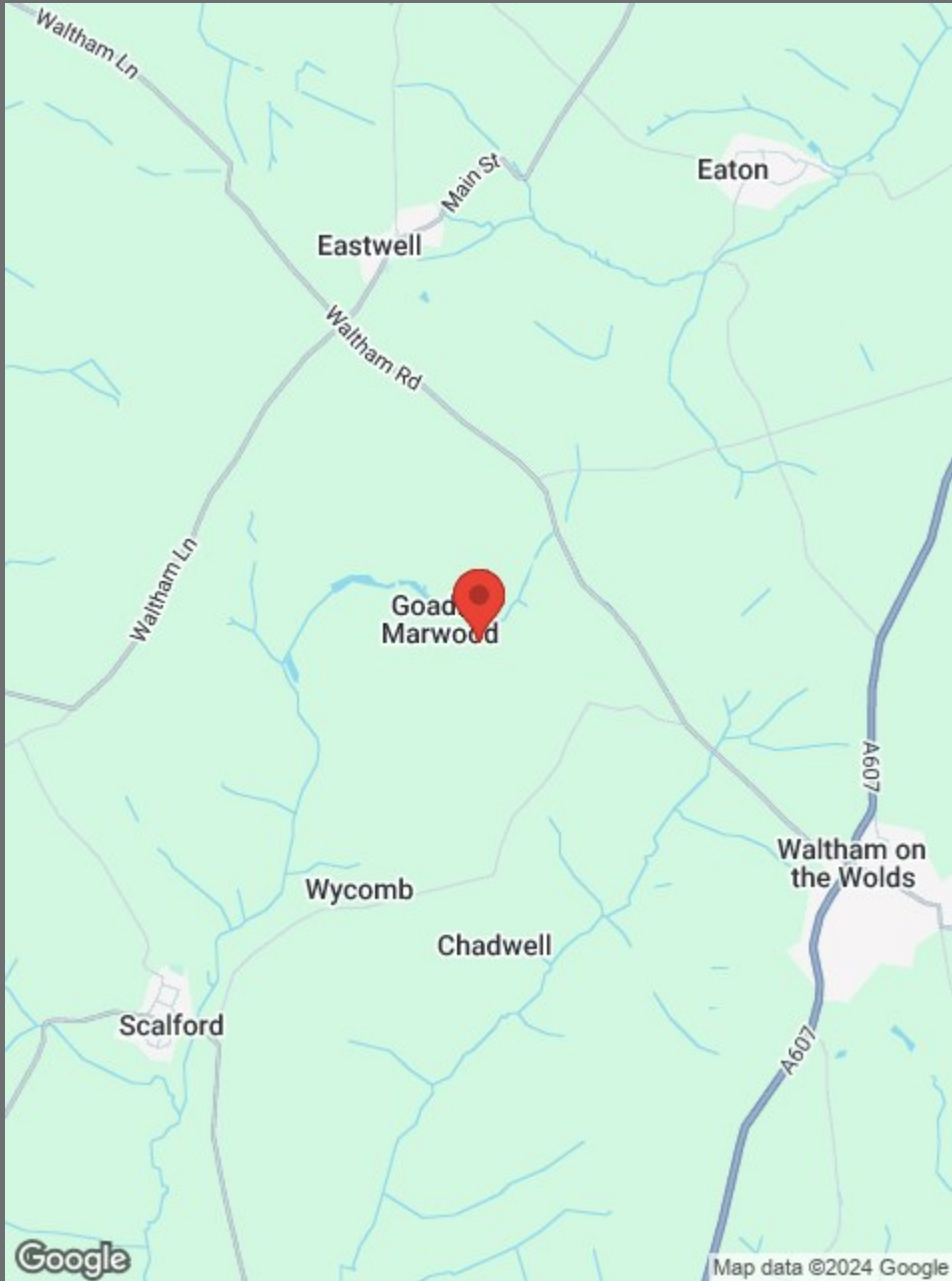

Illustration for identification purposes only, measurements are approximate, not to scale.
JonHolmesPhotography © 2024





- Detached Cottage Village Location
- Four Bedrooms
- Spacious Living Room
- Kitchen / Dining Family Room
- Driveway Parking
- Enclosed Gardens
- Inglenook Fireplace
- No Chain Sale





County Chambers, Kings Road,
Melton Mowbray, Leicestershire LE13 1QF

Tel: 01664 560181

www.shoulers.co.uk
housesales@shoulers.co.uk
lettings@shoulers.co.uk

**Shouler & Son**
Land & Estate Agents, Valuers & Auctioneers

We produce property particulars in good faith and believe them to be correct. We generally rely on what we are told without obtaining proof. You should verify for yourself such information before entering into a contract to take this property. Neither Shouler & Son nor their clients guarantee accuracy of the particulars, and they are not intended to form any part of a contract. No person in the employment of Shouler & Son has authority to give any representation or warranty in respect of this property.