



**OVER 60?**

Secure this property  
for up to **59% less!**

**Price**

**£260,000**

**Leasehold**

2x  1x  1x 

**Lowcay Road, Southsea,  
Hampshire, PO5**

**cubitt & west**  
Helping you move forwards





## Main features

- Own entrance
- Private enclosed rear garden
- Spacious and bright throughout
- Requested tree-lined street in Southsea
- Central location close to shops and amenities

## Accommodation

### GROUND FLOOR

#### Entrance Hallway

Lounge: 13'10 x 11'8 (4.22m x 3.56m)

Bedroom 1: 13'10 x 9'5 (4.22m x 2.87m)

Bedroom 2: 12'5 x 6'10 (3.79m x 2.08m)

Kitchen: 10'1 x 7'7 (3.08m x 2.31m)

Bathroom

### OUTSIDE

Private Rear Garden

**Ground Floor**  
Approx. 61.6 sq. metres (662.9 sq. feet)

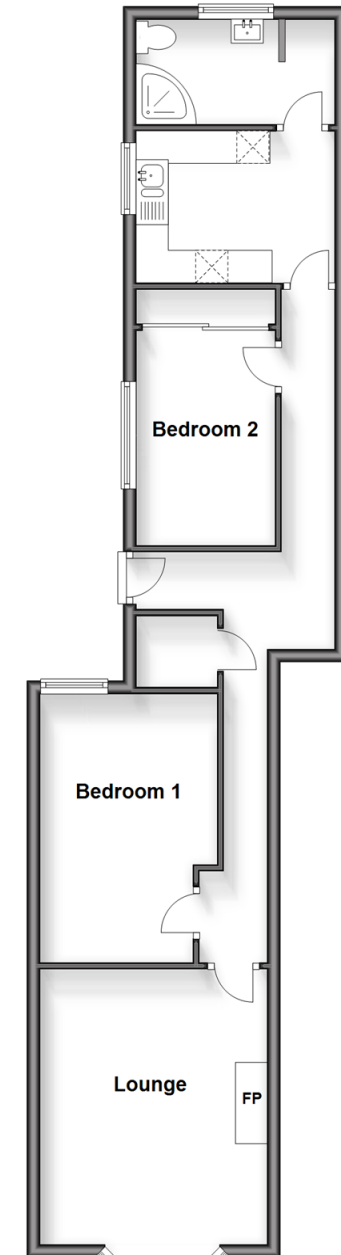

**Call Southsea - 023 9229 6396 ■ [cubittandwest.co.uk](http://cubittandwest.co.uk)**

- Legal advice should be taken to verify fixtures/fittings, planning, alterations and/or lease details
- Appliances & services are untested, dimensions are approximate and floor plans are not to scale
- Through a Homewise Home For Life Plan people aged 60+ can secure this property for up to 59% less, by purchasing a Lifetime Lease.



42226569/20250210/TH/SA