



Price
£110,000

Leasehold

2x  1x  1x 

**Nancy Road,
Portsmouth, Hampshire,
PO1**

OVER 60?

Secure this property
for up to **59% less!**

cubitt&west
Helping you move forwards



First Floor

Approx. 61.0 sq. metres (656.4 sq. feet)

Main features

- First come first serve parking
- Balcony off the lounge
- Excellent public transport links
- Open plan kitchen
- Close to all local daily amenities and transport links

Accommodation

FIRST FLOOR

Entrance Hallway

Lounge: 13'9 x 11'5 (4.19m x 3.48m)

Kitchen: 11'1 x 8'4 (3.38m x 2.54m)

Bathroom: 7'6 x 6'10 (2.29m x 2.08m)

Bedroom 1: 12'4 x 8'10 (3.76m x 2.69m)

Bedroom 2: 10'1 x 8'10 (3.08m x 2.69m)

OUTSIDE

First Come First Serve Parking

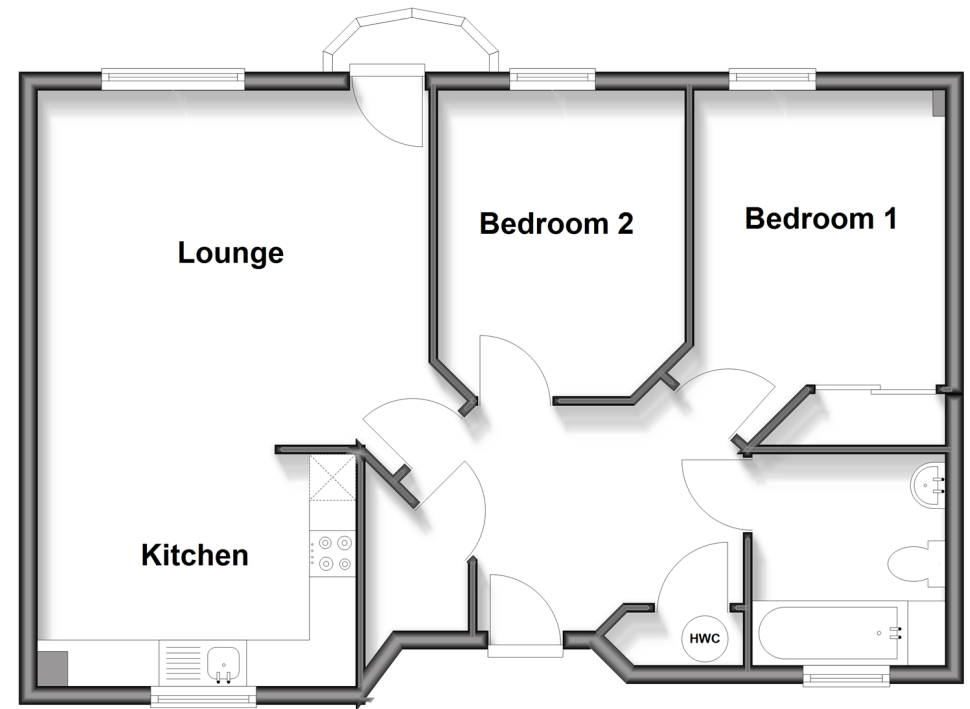

Call Portsmouth - 023 9266 1213 ■ cubittandwest.co.uk

- A private rental licensing scheme applies to some properties in this area, please contact us before proceeding
- Appliances & services are untested, dimensions are approximate and floor plans are not to scale

- Legal advice should be taken to verify fixtures/fittings, planning, alterations and/or lease details
- Through a Homewise Home For Life Plan people aged 60+ can secure this property for up to 50% less, by purchasing a Lifetime Lease.