



**Price**  
**£145,000**

**Leasehold**

2x  1x  1x 

**Adames Road,  
Portsmouth, Hampshire,  
PO1**

**OVER 60?**

Secure this property  
for up to **59% less!**

**cubitt&west**  
Helping you move forwards





## Main features

- Open plan lounge and kitchen area
- Sunny aspect courtyard garden with shed
- Minutes from local amenities
- Excellent transport links in and around town
- Ground floor with secure intercom access

## Accommodation

### GROUND FLOOR

Entrance Hallway

Lounge/Kitchen: 15'3 x 10'10 (4.65m x 3.30m)

Bathroom

Bedroom 1: 13'3 x 8'6 (4.04m x 2.59m)

Bedroom 2: 7'7 x 7'6 (2.31m x 2.29m)

### OUTSIDE

Courtyard with brick shed

**Ground Floor**  
Approx. 44.1 sq. metres (474.3 sq. feet)

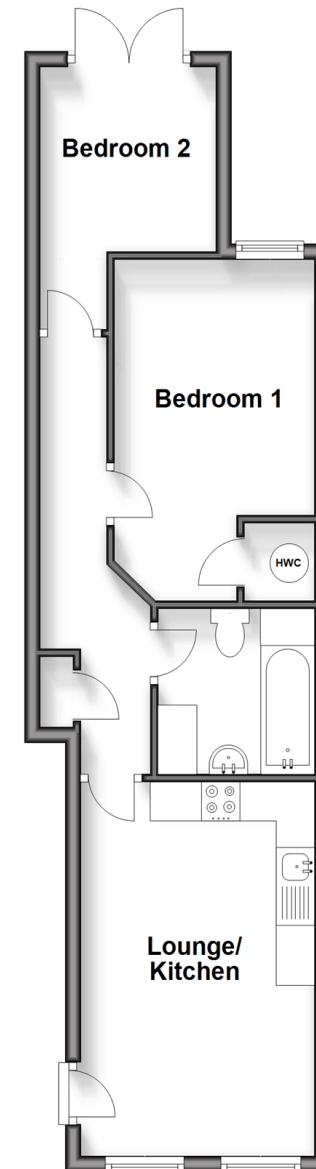

**Call Portsmouth - 023 9266 1213 ■ [cubittandwest.co.uk](http://cubittandwest.co.uk)**

- Legal advice should be taken to verify fixtures/fittings, planning, alterations and/or lease details
- Appliances & services are untested, dimensions are approximate and floor plans are not to scale
- Through a Homewise Home For Life Plan people aged 60+ can secure this property for up to 59% less, by purchasing a Lifetime Lease.



42227360/20250123/MO1/MH