



Price
£365,000

Freehold

3x  1x  1x 

**Bramber Avenue North,
Peacehaven, East
Sussex, BN10**

OVER 60?

Secure this property
for up to **59% less!**

cubitt & west
Helping you move forwards



Main features

- Detached bungalow with no onward chain
- Situated in a cul-de-sac location
- Low maintenance garden
- Close to local schools
- Benefits from a garage and off-road parking

Accommodation

GROUND FLOOR

Hallway

Lounge/Dining Room: 20'2 x 15'8
(6.15m x 4.78m)

Kitchen: 11'3 x 10'6 (3.43m x 3.20m)

Bedroom 3: 10'2 x 8'10 (3.10m x 2.69m)

Shower Room

Cloakroom

Bedroom 1: 14'4 x 11'1 (4.37m x 3.38m)

Bedroom 2: 11'4 x 10'4 (3.46m x 3.15m)

OUTSIDE

Front & Rear Garden

Driveway & Garage

Ground Floor
Approx. 89.1 sq. metres (959.4 sq. feet)

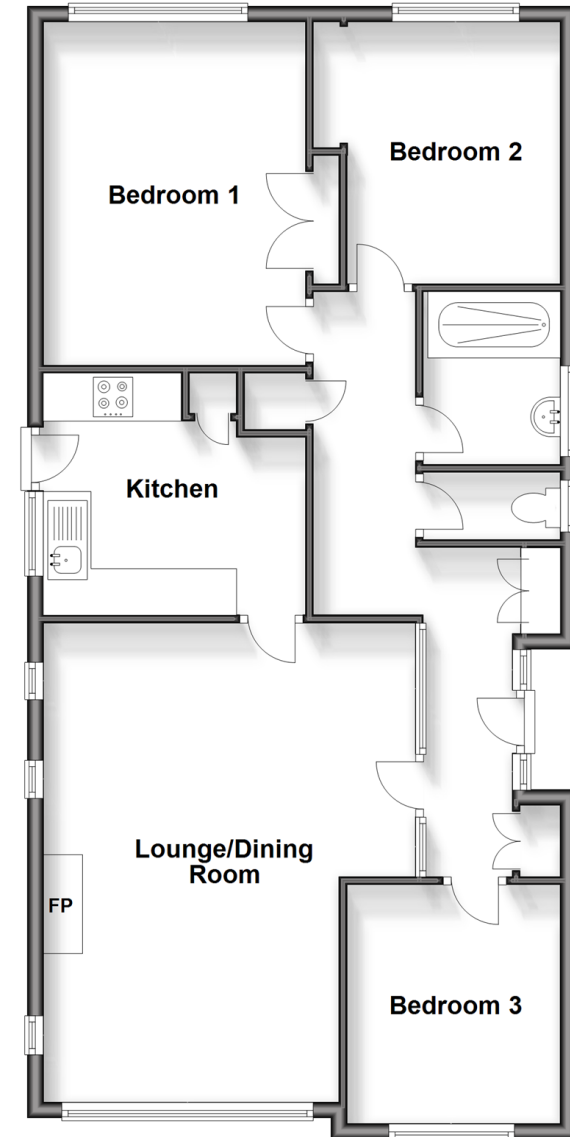

Call Peacehaven - 01273 584511 ■ cubittandwest.co.uk

- Legal advice should be taken to verify fixtures/fittings, planning, alterations and/or lease details
- Appliances & services are untested, dimensions are approximate and floor plans are not to scale
- Through a Homewise Home For Life Plan people aged 60+ can secure this property for up to 59% less, by purchasing a Lifetime Lease.



31804635/20240426/CY/GH