



Price
£365,000

Freehold

2x  2x  1x 

**Plot 34 Bermuda Road,
Grasmere Gardens
(Phase 1), Whitstable,
Kent, CT5**

Wards
Helping you move forwards



Main features

- Flexible open plan ground floor living with French doors leading to the rear garden
- Bespoke design fitted kitchen
- Bosch appliances
- Ground floor cloakroom
- Bedroom 1 includes an en-suite shower room and fitted wardrobes

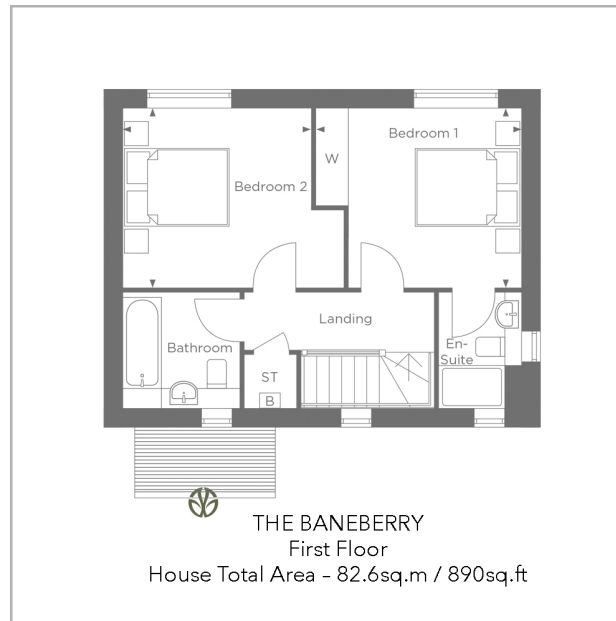
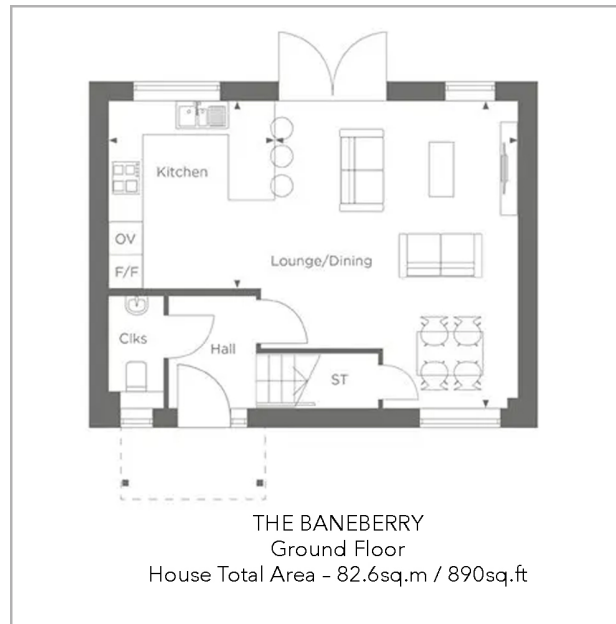

Accommodation

GROUND FLOOR

Entrance Hallway

Cloakroom

Kitchen: 11'1 x 8'9 (3.38m x 2.67m)

Lounge/Dining: 18'6 x 15'4 (5.64m x 4.68m)

FIRST FLOOR

Landing

Bedroom 1: 12'4 x 10'9 (3.76m x 3.28m)

En suite Shower Room

Bedroom 2: 13'5 x 11'0 (4.09m x 3.36m)

Bathroom

OUTSIDE

Front Garden

Driveway

Rear Garden

Call Whitstable - 01227 772272 ■ wardsofkent.co.uk

- If buying to let, the energy rating will need to be improved to at least 'E' rating before you can let the property
- Appliances & services are untested, dimensions are approximate and floor plans are not to scale

- Legal advice should be taken to verify fixtures/fittings, planning, alterations and/or lease details



12033728/20250326/AR/NF