



**Price**  
**£475,000**

**Freehold**

2x  1x  1x 

**Multon Road, West  
Kingsdown, Sevenoaks,  
Kent, TN15**

**OVER 60?**

Secure this property  
for up to **59% less!**

*Wards*  
Helping you move forwards





## Main features

- Large drive for multiple cars
- Newly fitted kitchen/diner
- Lounge with log burner
- Bright and spacious conservatory overlooking private garden
- Close to key routes into London via A20/M20 and M25

## Accommodation

### GROUND FLOOR

Entrance Hall

Kitchen: 14'0 x 10'10 (4.27m x 3.30m)

Lounge: 17'11 x 10'6 (5.46m x 3.20m)

Conservatory: 20'2 x 9'6 (6.15m x 2.90m)

Bedroom 1: 14'4 x 9'2 (4.37m x 2.80m)

Bedroom 2: 11'3 x 8'6 (3.43m x 2.59m)

Bathroom

### OUTSIDE

Garage & Driveway

Rear Garden

## Ground Floor

Approx. 84.7 sq. metres (912.1 sq. feet)

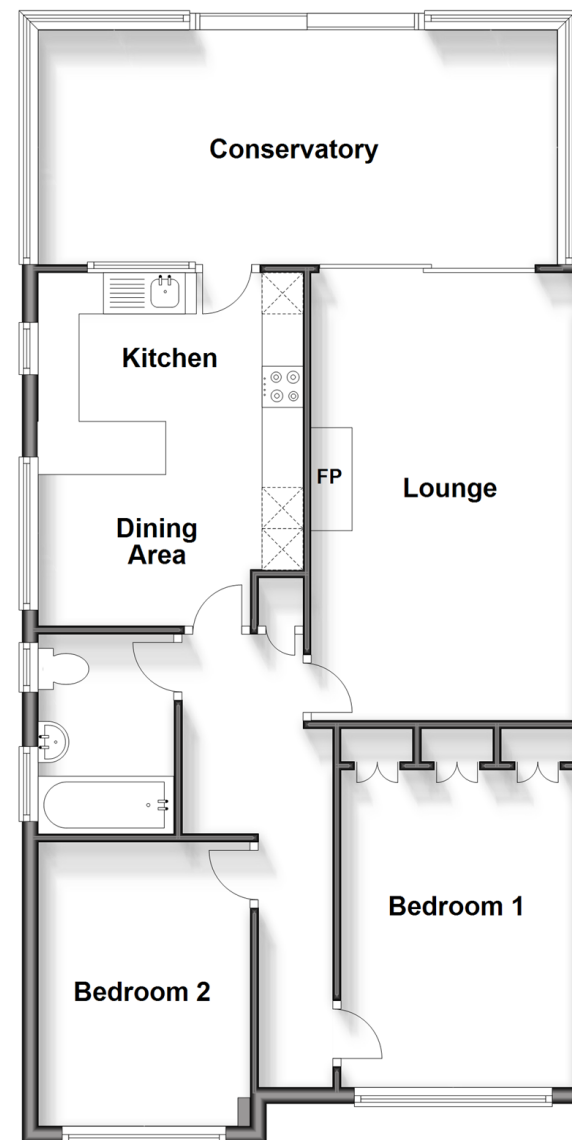

**Call West Kingsdown - 01474 852816 ■ [wardsofkent.co.uk](http://wardsofkent.co.uk)**

- Legal advice should be taken to verify fixtures/fittings, planning, alterations and/or lease details
- Appliances & services are untested, dimensions are approximate and floor plans are not to scale
- Through a Homewise Home For Life Plan people aged 60+ can secure this property for up to 59% less, by purchasing a Lifetime Lease.

