

CPR Certificate Not Signed

Price

£900,000

Freehold

2x  1x  2x 

Stone Street Road, Ivy
Hatch, Sevenoaks, Kent,
TN15

OVER 60?

Secure this property
for up to **59% less!**

Wards
Helping you move forwards



Ground Floor
Approx: 108.8 sq. metres (1164.5 sq. feet)

Main features

- **Potential, Potential, Potential**
- **Parking for several cars**
- **Original Outbuildings**
- **Set within private walled grounds of the original Ivy Hatch Court**
- **Stunning views from every aspect, as well as over the adjoining fields**

Accommodation

GROUND FLOOR

Sitting Area: 11'7 x 11'3 (3.53m x 3.43m)
 Dining Area: 11'7 x 11'6 (3.53m x 3.51m)
 Cloakroom: 7'7 x 3'4 (2.31m x 1.02m)
 Living Room: 19'5 x 19'4 (5.92m x 5.90m)
 Sun Room: 19'2 x 7'9 (5.85m x 2.36m)
 Hallway
 Study: 19'5 x 11'1 (5.92m x 3.38m)
 Kitchen: 11'4 x 10'7 (3.46m x 3.23m)
 Bedroom 1: 16'1 x 12'1 (4.91m x 3.69m)
 Bedroom 2: 15'5 x 9'7 (4.70m x 2.92m)
 Bathroom: 8'4 x 7'9 (2.54m x 2.36m)

OUTSIDE

Driveway
 Rear Garden
 Outbuilding 1
 Outbuilding 2

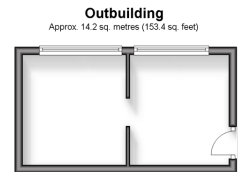

Outbuilding
Approx: 6.3 sq. metres (67.3 sq. feet)



Call West Kingsdown - 01474 852816 ■ wardsofkent.co.uk

- If buying to let, the energy rating will need to be improved to at least 'E' rating before you can let the property
- Appliances & services are untested, dimensions are approximate and floor plans are not to scale

- Legal advice should be taken to verify fixtures/fittings, planning, alterations and/or lease details
- Through a Homewise Home For Life Plan people aged 60+ can secure this property for up to 59% less, by purchasing a Lifetime Lease.



14419572/20240715/DW/JS