



OVER 60?

Secure this property
for up to **59% less!**

Price

£280,000

Freehold

2x  1x  1x 

**Conifer Drive, Lords
Wood, Chatham, Kent,
ME5**



Wards
Helping you move forwards



Main features

- Beautiful semi detached house with garage and driveway
- Double bedrooms for the growing family or home/office
- The potential to extend subject to the normal planning consents
- Close to local shops and amenities
- A short drive to the M2/M20 motorway connections

Accommodation

GROUND FLOOR

Entrance Porch

Lounge : 15'9 x 13'0 (4.80m x 3.97m)

Kitchen/Diner: 13'0 x 8'9 (3.97m x 2.67m)

FIRST FLOOR

Landing

Bedroom 1 : 11'6 x 9'8 (3.51m x 2.95m)

Bedroom 2 : 13'0 x 9'0 (3.97m x 2.75m)

Bathroom : 7'3 x 7'2 (2.21m x 2.19m)

OUTSIDE

Front Garden

Garage and Driveway

Rear Garden

Ground Floor

Approx. 45.8 sq. metres (492.6 sq. feet)

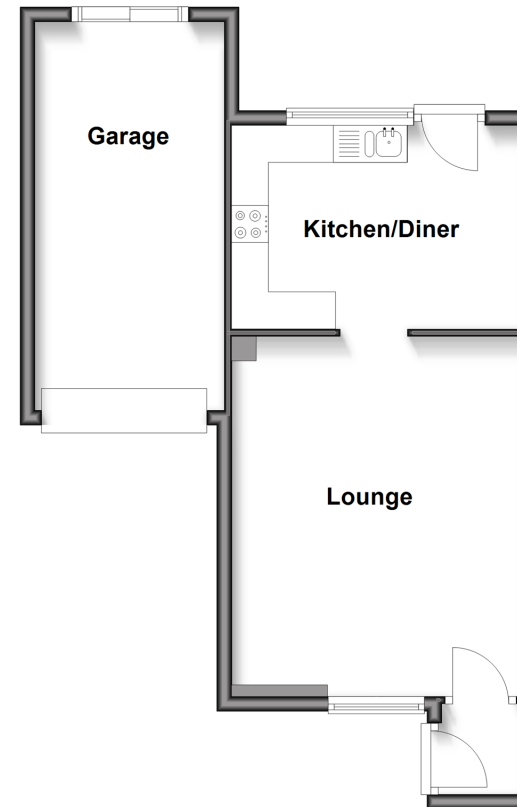

First Floor

Approx. 30.4 sq. metres (327.7 sq. feet)

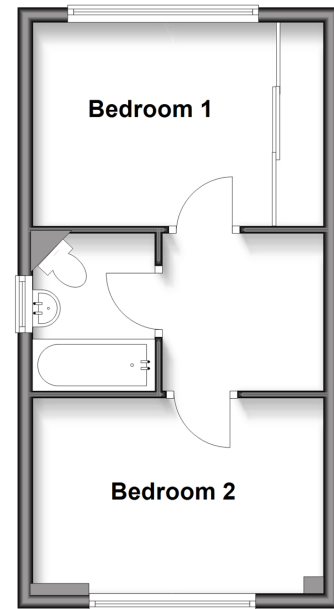

Call Walderslade - 01634 865661 ■ wardsof Kent.co.uk

- Legal advice should be taken to verify fixtures/fittings, planning, alterations and/or lease details
- Appliances & services are untested, dimensions are approximate and floor plans are not to scale
- Through a Homewise Home For Life Plan people aged 60+ can secure this property for up to 59% less, by purchasing a Lifetime Lease.



12141347/20250303/ML/AH