



Price
£200,000

Freehold

2x  1x  1x 

**Levett Close, Isle Of
Grain, Rochester, Kent,
ME3**

OVER 60?

Secure this property
for up to **59% less!**

Wards
Helping you move forwards



Main features

- Driveway to front and garage en-bloc
- Perfect for first time buyers
- Some updating and modernisation required
- Village location; within walking distance of Grain Coastal Path
- Close to local convenience store, recreation ground and village pub

Accommodation

GROUND FLOOR

Entrance Hall

Lounge: 16'5 x 13'4 (5.01m x 4.07m)

Kitchen/Dining Area: 13'4 x 7'1 (4.07m x 2.16m)

FIRST FLOOR

Landing

Bedroom 1: 13'5 x 9'10 (4.09m x 3.00m)

Bedroom 2: 13'5 x 7'3 (4.09m x 2.21m)

Bathroom

OUTSIDE

Driveway

Garage en-bloc

Rear Garden

Ground Floor

Approx. 31.5 sq. metres (338.6 sq. feet)

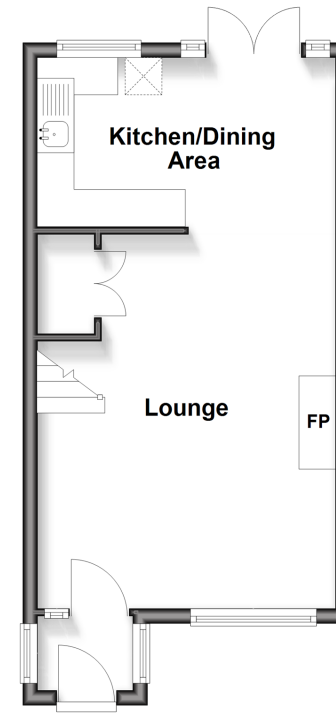

First Floor

Approx. 30.0 sq. metres (323.2 sq. feet)

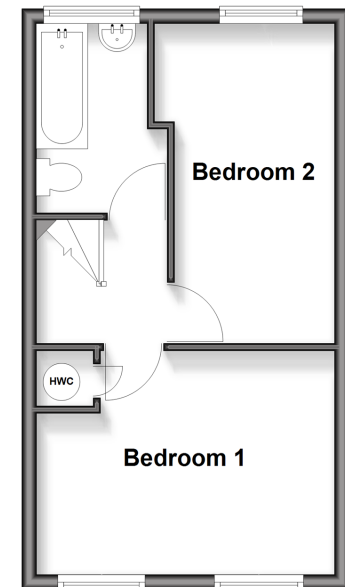

Call Strood - 01634 716597 ■ wardsofkent.co.uk

- The seller is a person connected with Wards as defined in the Estate Agents Act 1979
- Appliances & services are untested, dimensions are approximate and floor plans are not to scale

- Legal advice should be taken to verify fixtures/fittings, planning, alterations and/or lease details
- Through a Homewise Home For Life Plan people aged 60+ can secure this property for up to 59% less, by purchasing a Lifetime Lease.



11846666/20250710/DV/CM