



**Guide Price**  
**£335,000**

**Freehold**

3x  1x  2x 

**Fenn Street, St. Mary  
Hoo, Rochester, Kent,  
ME3**

**OVER 60?**

Secure this property  
for up to **59% less!**

*Wards*  
Helping you move forwards



## Main features

- Ideal for families with its semi rural location and great schooling
- Short drive from amenities and shops
- Surrounded by countryside
- Ideally located for transport links
- Great scope to add value with a usable loft room and newly built garage to the rear

## Accommodation

### GROUND FLOOR

Entrance Porch  
 Entrance Hall  
 Lounge/Dining Area: 22'0 x 12'11 (6.71m x 3.94m)  
 Kitchen: 8'2 x 7'11 (2.49m x 2.41m)

### FIRST FLOOR

Landing  
 Bedroom 1: 16'10 x 11'3 (5.13m x 3.43m)  
 Bedroom 2: 11'3 x 10'2 (3.43m x 3.10m)  
 Bedroom 3: 8'3 x 7'4 (2.52m x 2.24m)  
 Bathroom : 8'6 x 8'1 (2.59m x 2.47m)

### OUTSIDE

Driveway  
 Garage: 22'0 x 16'0 (6.71m x 4.88m)  
 Rear Garden

**Ground Floor**  
 Approx. 40.9 sq. metres (439.9 sq. feet)

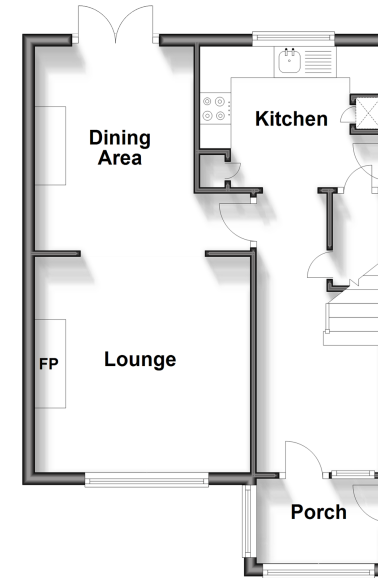

**First Floor**  
 Approx. 38.0 sq. metres (408.5 sq. feet)

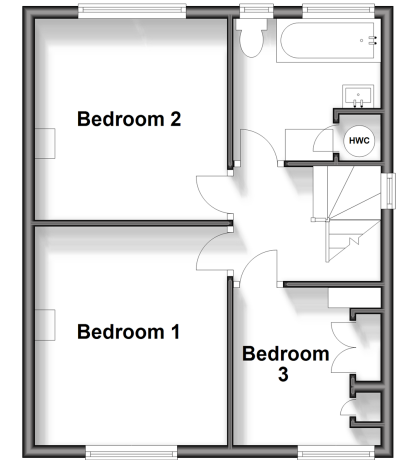

**Outbuilding**  
 Approx. 0.0 sq. metres (0.0 sq. feet)

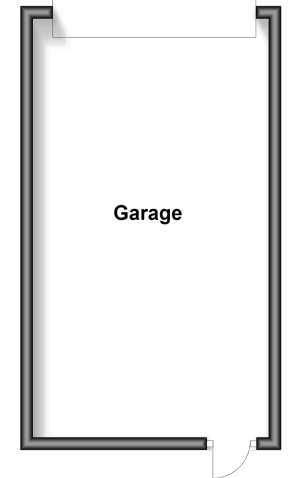

**Call Strood - 01634 716597 ■ [wardsof Kent.co.uk](http://wardsof Kent.co.uk)**

- Legal advice should be taken to verify fixtures/fittings, planning, alterations and/or lease details
- Appliances & services are untested, dimensions are approximate and floor plans are not to scale
- Through a Homewise Home For Life Plan people aged 60+ can secure this property for up to 59% less, by purchasing a Lifetime Lease.



11845992/20240427/DV/DM