



Guide Price
£290,000

Freehold

3x  1x  1x 

Beechwood Close, St.
Mary's Bay, Kent, TN29

OVER 60?

Secure this property
for up to **59% less!**

Wards
Helping you move forwards



Main features

- Quiet mews of similar homes
- Walking distance to local shops and the beach
- Garage and excellent off road parking
- No onward chain quick sale available
- Short drive to Dymchurch and New Romney

Accommodation

GROUND FLOOR

Entrance Hall

Kitchen: 12'5 x 7'10 (3.79m x 2.39m)

Lounge: 19'5 x 10'5 (5.92m x 3.18m)

Inner Hallway

Bedroom 1: 11'6 x 11'0 (3.51m x 3.36m)

Bedroom 2: 10'8 x 8'8 (3.25m x 2.64m)

Bedroom 3: 7'1 x 6'7 (2.16m x 2.01m)

Shower Room

OUTSIDE

Off Road Parking

Garage

Front & Rear Gardens

Ground Floor

Approx. 64.8 sq. metres (697.9 sq. feet)

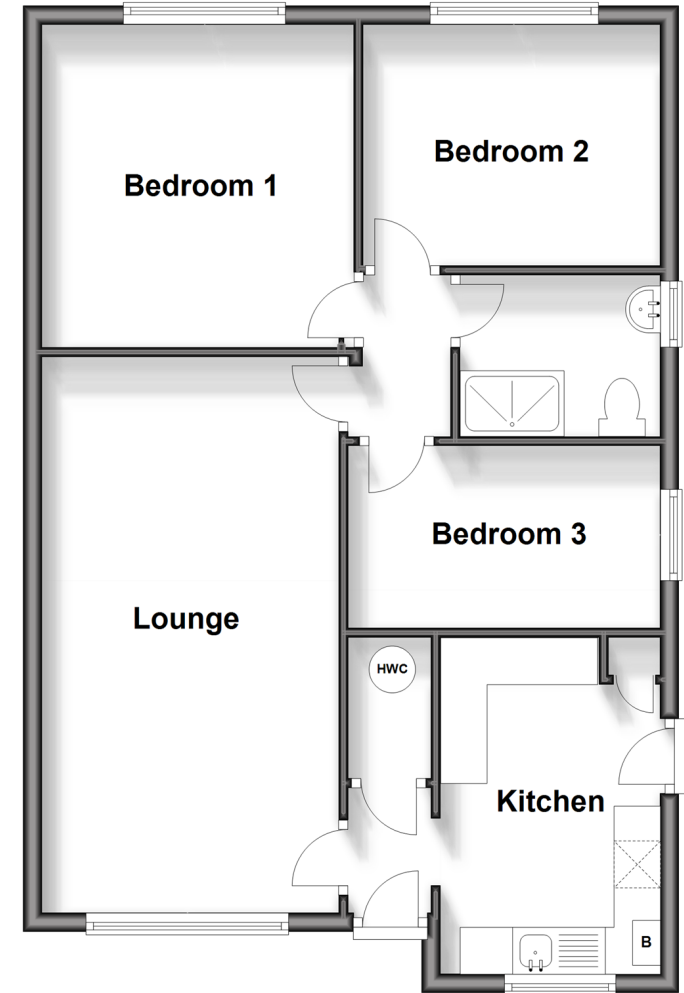

Call New Romney - 01797 363745 ■ wardsforkent.co.uk

- Legal advice should be taken to verify fixtures/fittings, planning, alterations and/or lease details
- Appliances & services are untested, dimensions are approximate and floor plans are not to scale
- Through a Homewise Home For Life Plan people aged 60+ can secure this property for up to 59% less, by purchasing a Lifetime Lease.



13525440/20240916/AH/CA