



Price
£475,000

Freehold

3x  1x  2x 

Fairview, Fawkham
Green Road, Longfield,
Kent, DA3

OVER 60?

Secure this property
for up to **59% less!**

Wards
Helping you move forwards



Main features

- Large front and rear gardens with private and secure parking
- Good size living space fitted with a wood burner
- Bedrooms offer a great space
- Free residents pass to Brands Hatch race circuit
- Planning permission obtained for single storey extension

Accommodation

GROUND FLOOR

Hallway

Living Room: 20'1 x 15'7 (6.13m x 4.75m)

Dining Room: 18'2 x 16'7 (5.54m x 5.06m)

Kitchen: 16'8 x 8'0 (5.08m x 2.44m)

FIRST FLOOR

Landing

Bedroom 1: 12'9 x 10'11 (3.89m x 3.33m)

Bedroom 2: 9'3 x 8'0 (2.82m x 2.44m)

Bedroom 3: 9'2 x 9'2 (2.80m x 2.80m)

Bathroom

OUTSIDE

Front Garden

Rear Garden

3 Parking Bays to the Rear

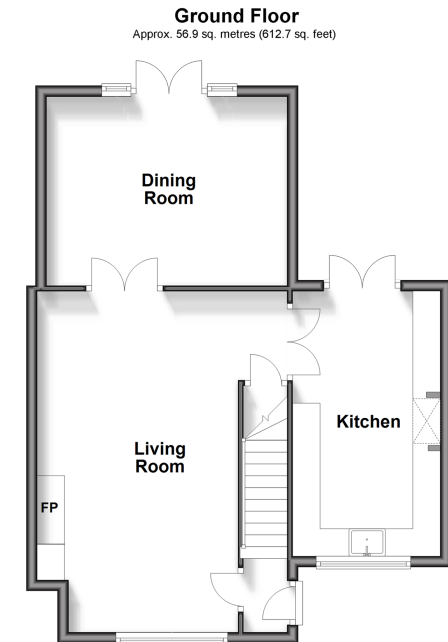
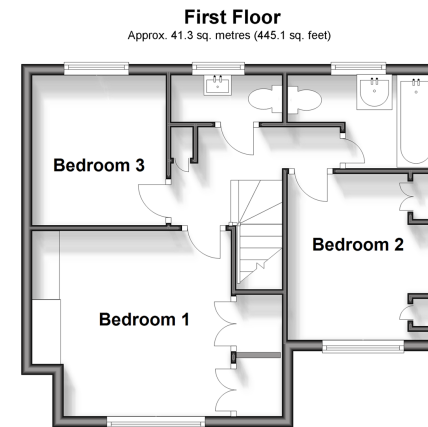

Call New Ash Green - 01474 872466 ■ wardsof Kent.co.uk

- Legal advice should be taken to verify fixtures/fittings, planning, alterations and/or lease details
- Appliances & services are untested, dimensions are approximate and floor plans are not to scale
- Through a Homewise Home For Life Plan people aged 60+ can secure this property for up to 59% less, by purchasing a Lifetime Lease.



14419477/20240429/JH/JH