



Guide Price
£270,000

Freehold

2x  1x  1x 

**Orchard Close,
Coxheath, Maidstone,
Kent, ME17**

OVER 60?

Secure this property
for up to **59% less!**

Wards
Helping you move forwards



Main features

- Large loft that could be converted, subject to planning and consents
- Situated in a quiet cul de sac
- Popular village location
- Short walk to local shops and amenities
- NO FORWARD CHAIN

Accommodation

GROUND FLOOR

Entrance Porch
Hallway
Lounge/Diner: 15'1 x 11'1 (4.60m x 3.38m)
Conservatory: 9'0 x 8'0 (2.75m x 2.44m)
Kitchen: 12'1 x 10'0 (3.69m x 3.05m)
Bedroom 1: 12'0 x 11'0 (3.66m x 3.36m)
Bedroom 2: 10'1 x 10'1 (3.08m x 3.08m)
Shower Room: 6'0 x 5'1 (1.83m x 1.55m)

OUTSIDE

Garage and Driveway
Front and Rear Gardens
Greenhouse

Ground Floor

Approx. 76.9 sq. metres (827.9 sq. feet)

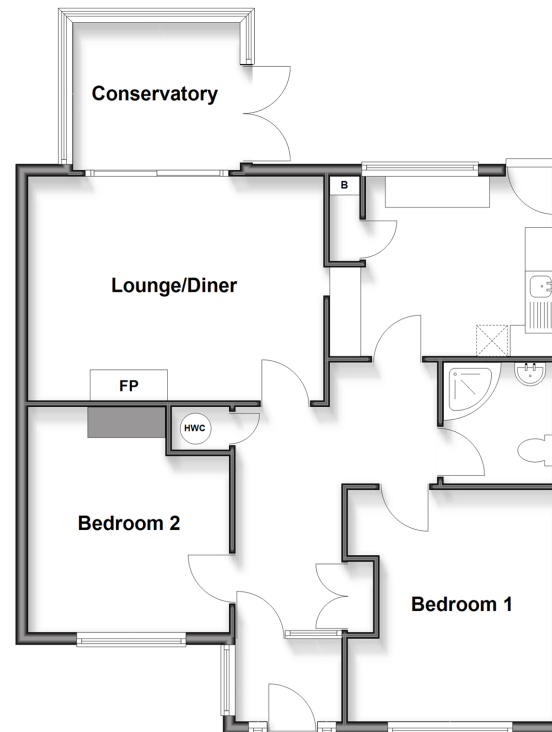

Call Loose - 01622 744067 ■ wardsof Kent.co.uk

■ Legal advice should be taken to verify fixtures/fittings, planning, alterations and/or lease details
■ Through a Homewise Home For Life Plan people aged 60+ can secure this property for up to 50% less, by purchasing a Lifetime Lease.

■ Appliances & services are untested, dimensions are approximate and floor plans are not to scale