



OVER 60?

Secure this property
for up to **59% less!**

Price

£350,000

Freehold

3x  1x  1x 

**Mill View Road, Herne
Bay, Kent, CT6**

Wards
Helping you move forwards



Main features

- No chain, vacant possession
- On the outskirts of the popular Herne village
- Large garage with driveway
- Wheelchair friendly alterations
- Large lounge with gas central heating

Accommodation

GROUND FLOOR

Entrance Hallway

Wet Room

Bedroom 2: 10'9 x 10'1 (3.28m x 3.08m)

Bedroom 1: 14'0 x 10'9 (4.27m x 3.28m)

Bedroom 3: 12'2 x 7'9 (3.71m x 2.36m)

Lounge/Diner: 17'4 x 11'4 (5.29m x 3.46m)

Kitchen: 11'4 x 8'9 (3.46m x 2.67m)

OUTBUILDING

Garage

OUTSIDE

Driveway

Front Garden

Rear Garden

Ground Floor
Approx. 85.9 sq. metres (924.9 sq. feet)

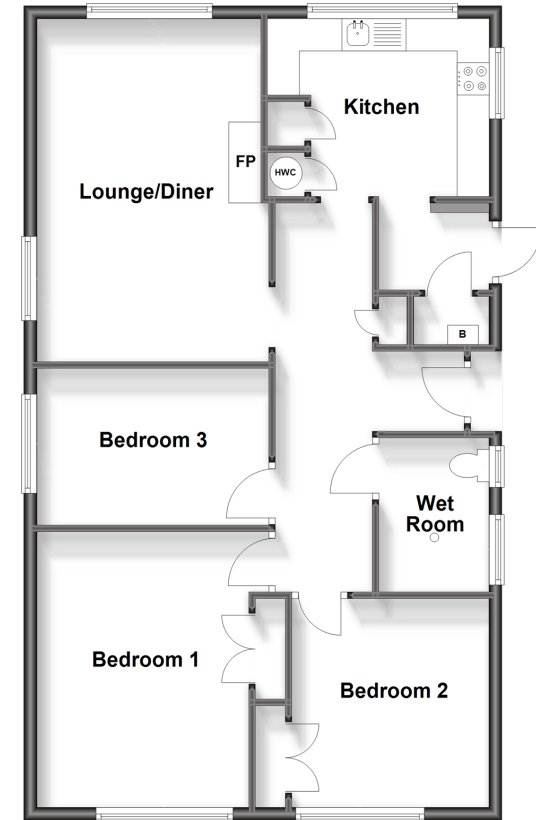

Outbuilding
Approx. 12.0 sq. metres (129.6 sq. feet)

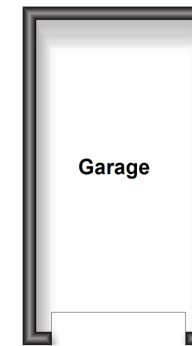

Call Herne Bay - 01227 361226 ■ wardsofkent.co.uk

- Legal advice should be taken to verify fixtures/fittings, planning, alterations and/or lease details
- Appliances & services are untested, dimensions are approximate and floor plans are not to scale
- Through a Homewise Home For Life Plan people aged 60+ can secure this property for up to 59% less, by purchasing a Lifetime Lease.



11238729/20250313/EM/GG