



Price
£495,000

Freehold

3x  1x  1x 

**Holmscroft Road, Herne
Bay, Kent, CT6**

OVER 60?

Secure this property
for up to **59% less!**

Wards
Helping you move forwards



Main features

- No Chain
- Showroom condition throughout
- Garage with large driveway for multiple cars
- Open plan layout perfect for entertaining
- Sought after Beltinge location

Accommodation

GROUND FLOOR

Lounge/Kitchen/Diner: 21'7 x 18'7
(6.58m x 5.67m)

Bedroom 3: 9'9 x 8'9 (2.97m x 2.67m)

Bedroom 1: 12'8 x 9'9 (3.86m x 2.97m)

Bedroom 2: 11'3 x 9'4 (3.43m x 2.85m)

Bathroom

OUTBUILDING

Garage

OUTSIDE

Driveway
Front Garden
Rear Garden

Ground Floor

Approx. 75.6 sq. metres (814.1 sq. feet)

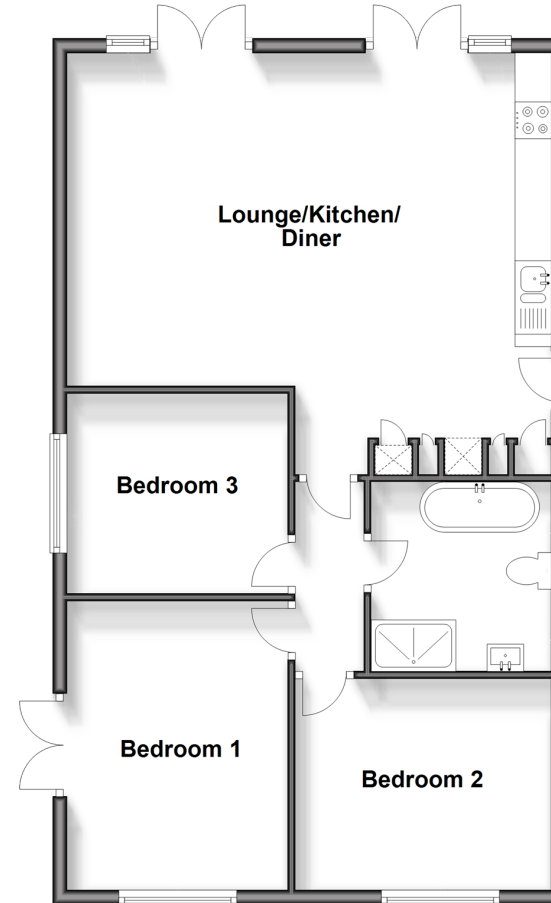

Outbuilding

Approx. 11.3 sq. metres (121.2 sq. feet)

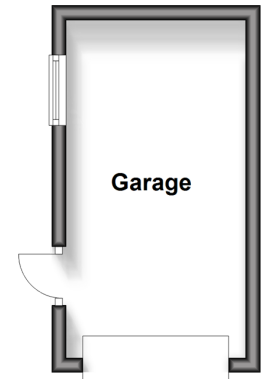

Call Herne Bay - 01227 361226 ■ wardsofkent.co.uk

- Legal advice should be taken to verify fixtures/fittings, planning, alterations and/or lease details
- Appliances & services are untested, dimensions are approximate and floor plans are not to scale
- Through a Homewise Home For Life Plan people aged 60+ can secure this property for up to 59% less, by purchasing a Lifetime Lease.



11238446/20240830/AR/AT