



OVER 60?

Secure this property
for up to **59% less!**

Price

£220,000

Freehold

2x  2x  2x 

**Green Street,
Gillingham, Kent, ME7**

Wards
Helping you move forwards



Main features

- Chain free
- Downstairs shower room and upstairs bathroom
- Gas central heating and double glazing
- Larger than average rooms with additional useful cellar
- Located within walking distance of Gillingham High Street and main line station

Accommodation

GROUND FLOOR

Lounge: 17'7 x 10'4 (5.36m x 3.15m)
 Dining Room: 13'4 x 10'6 (4.07m x 3.20m)
 Kitchen: 10'1 x 7'8 (3.08m x 2.34m)
 Shower Room

BASEMENT

Cellar: 13'7 x 10'4 (4.14m x 3.15m)

SPLIT LEVEL FIRST FLOOR

Landing
 Bedroom 1: 13'6 x 10'6 (4.12m x 3.20m)
 Bedroom 2: 13'6 x 10'6 (4.12m x 3.20m)
 Bathroom

OUTSIDE

Rear Garden

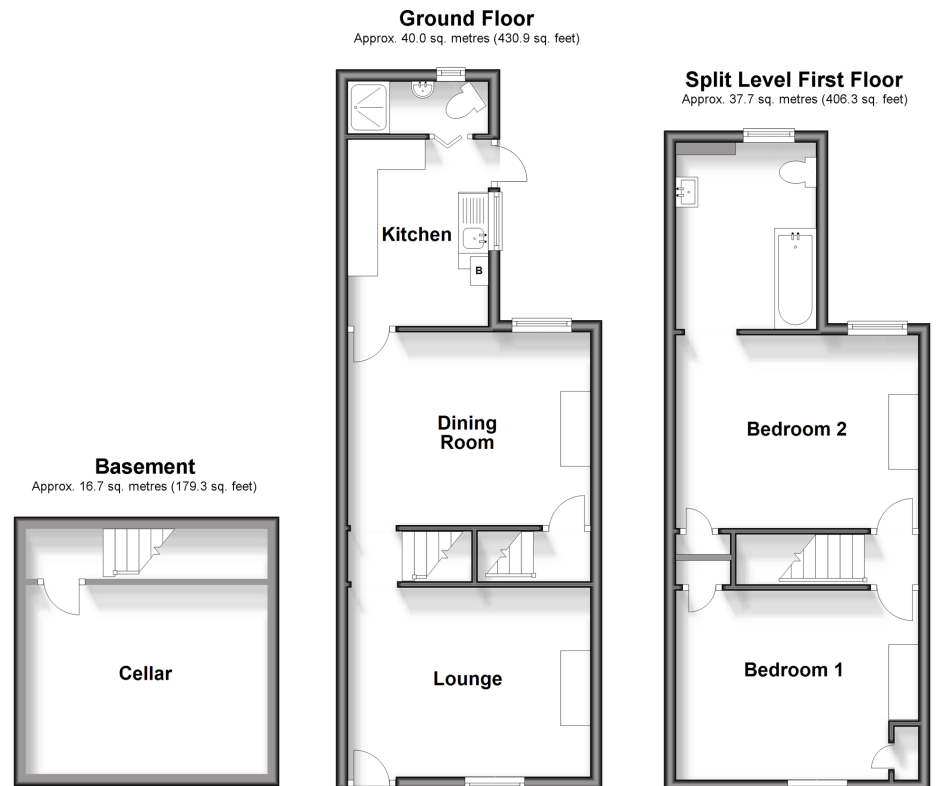

Call Gillingham - 01634 851191 ■ wardsofkent.co.uk

■ Legal advice should be taken to verify fixtures/fittings, planning, alterations and/or lease details
 ■ Through a Homewise Home For Life Plan people aged 60+ can secure this property for up to 59% less, by purchasing a Lifetime Lease.

■ Appliances & services are untested, dimensions are approximate and floor plans are not to scale