



Price
£160,000

Leasehold

1x  1x  1x 

**Mount Pleasant Road,
Folkestone, Kent, CT20**

OVER 60?

Secure this property
for up to **59% less!**

Wards
Helping you move forwards



Main features

- Recently renovated, key ready functioning Air BnB
- Ready to move straight into
- Perfect for first time buyers and buy-to-let investors
- No onward chain
- Added bonus of your own private garden

Accommodation

LOWER-GROUND FLOOR

Entrance Hall

Lounge: 11'6 x 9'8 (3.51m x 2.95m)

Kitchen: 12'5 x 10'4 (3.79m x 3.15m)

Bedroom : 11'5 x 10'4 (3.48m x 3.15m)

Bathroom

OUTSIDE

Private Garden

Lower Ground Floor

Approx. 42.1 sq. metres (452.9 sq. feet)

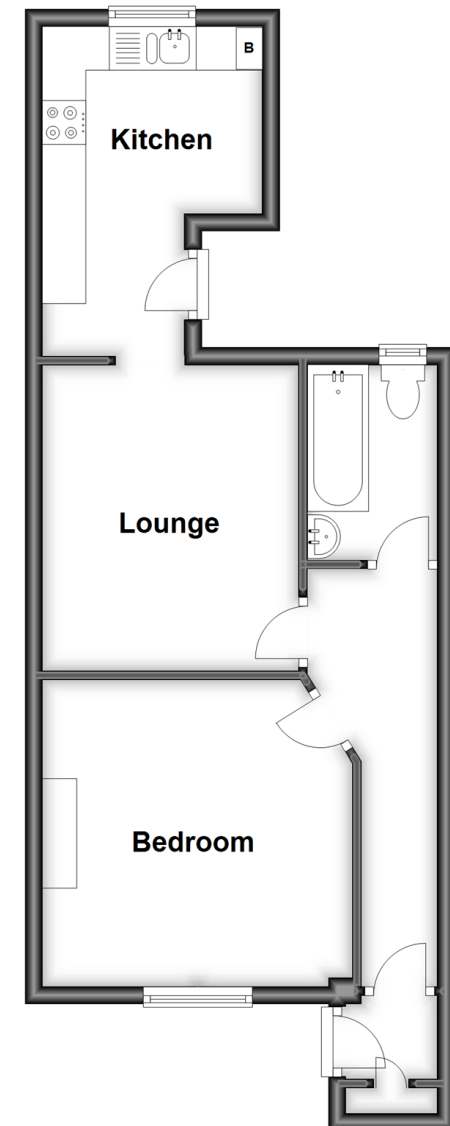

Call Folkestone - 01303 256505 ■ wardsofkent.co.uk

- Legal advice should be taken to verify fixtures/fittings, planning, alterations and/or lease details
- Appliances & services are untested, dimensions are approximate and floor plans are not to scale
- Through a Homewise Home For Life Plan people aged 60+ can secure this property for up to 59% less, by purchasing a Lifetime Lease.



12637161/20250205/LS/CW