



Price
£120,000

Leasehold

1x  1x  1x 

**Homepine House,
Sandgate Road,
Folkestone, Kent, CT20**

OVER 60?

Secure this property
for up to **59% less!**



Video Tour available

Wards

Helping you move forwards

Ground Floor

Approx. 49.6 sq. metres (533.8 sq. feet)

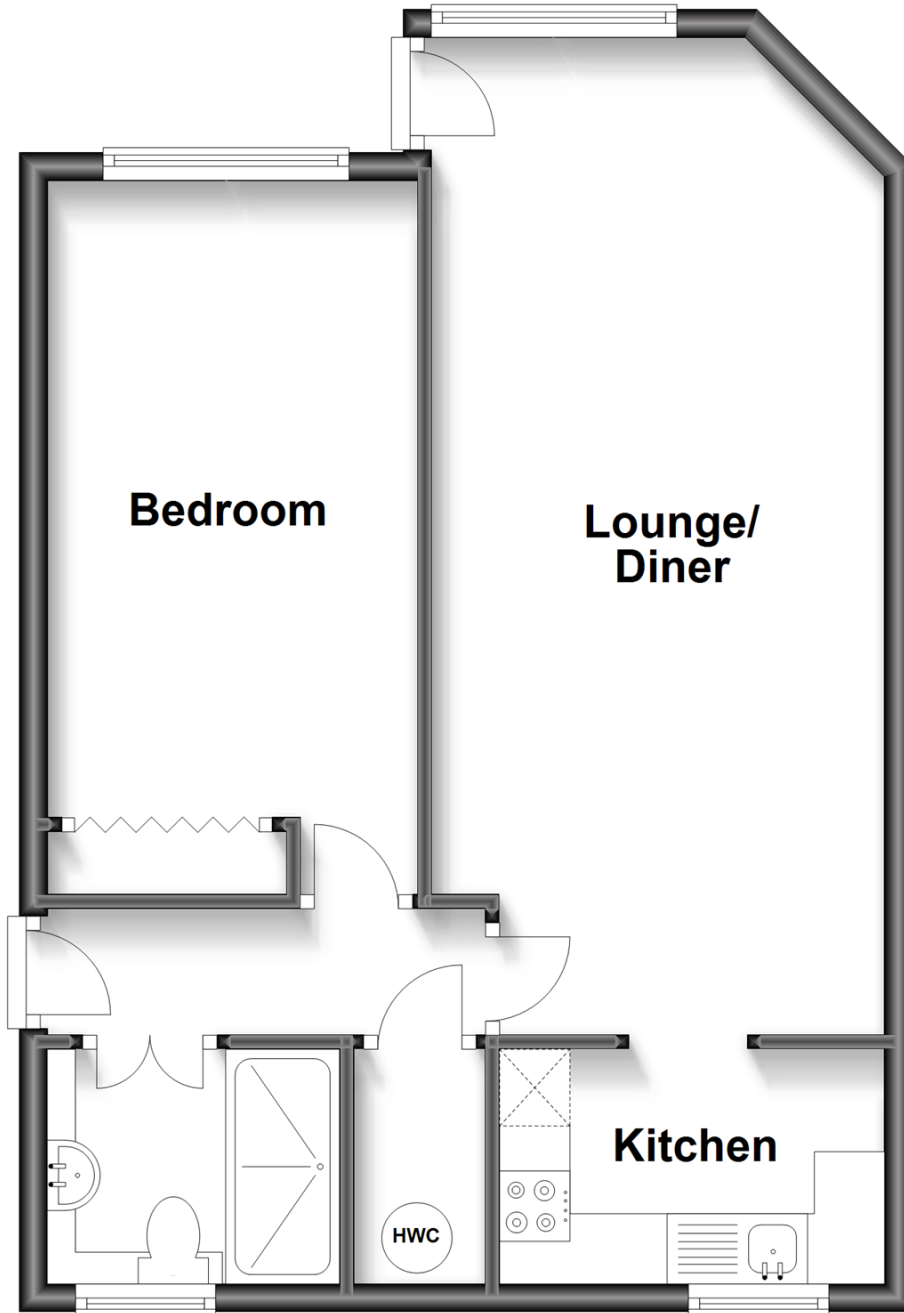

Accommodation

GROUND FLOOR

Hallway

Kitchen: 8'11 x 5'7 (2.72m x 1.70m)

Lounge/Diner: 21'0 x 10'7 (6.41m x 3.23m)

Bedroom: 14'0 x 8'9 (4.27m x 2.67m)

Bathroom

OUTSIDE

Private Patio



Main features

- Over 60's ground floor retirement flat - 24 hour emergency call system
- Own patio and garden with direct access onto the Leas
- Short walk into town for all shopping needs, coffee shops and eateries
- Existing lease extended
- No onward chain giving a fuss free move

Nearest Schools

Primary Schools: Folkestone Christ Church CofE Primary 0.6 miles, Lympe C of E Primary 0.8 miles, Park Farm Primary 0.8 miles

Secondary Schools: The Folkestone School for Girls 0.9

Transport Information

Train Stations: Folkestone Central 0.6 miles, Folkestone West High Speed Link 1.2 miles, Dover Priory 6.7 miles

Address

Homepine House, Sandgate Road, Folkestone, Kent, CT20

Directions

For directions to this property please contact us.



Wards
Helping you move forwards

Call Folkestone Branch 01303 256505 ■ wardsof Kent.co.uk



- Legal advice should be taken to verify fixtures/fittings, planning, alterations and/or lease details
- Appliances & services are untested, dimensions are approximate and floor plans are not to scale
- Through a Homewise Home For Life Plan people aged 60+ can secure this property for up to 59% less, by purchasing a Lifetime Lease.

EPC RATING: CURRENT: **C(71)** POTENTIAL: **C(79)**

12637163/20231122/LS1/AP1