



OVER 60?

Secure this property
for up to **59% less!**

Price

£250,000

Leasehold

2x  1x  1x 

**Old Mill Close, Eynsford,
Kent, DA4**

Wards
Helping you move forwards



Main features

- Ground floor apartment with good size bedrooms
- No onward chain
- Leasehold with 158 years remaining
- Garage and one allocated parking space
- Private patio and communal garden

Accommodation

GROUND FLOOR

Hallway: 13'2 x 3'2 (4.02m x 0.97m)

Lounge: 16'6 x 12'7 (5.03m x 3.84m)

Kitchen: 10'6 x 6'11 (3.20m x 2.11m)

Bathroom: 6'10 x 5'6 (2.08m x 1.68m)

Bedroom 1: 16'6 into fitted wardrobes x 10'8 (5.03m x 3.25m)

Bedroom 2: 12'10 x 8'9 (3.91m x 2.67m)

OUTSIDE

Communal Garden

Garage

Allocated Parking Space: 17'1 x 8'7 (5.21m x 2.62m)

Ground Floor

Approx. 62.1 sq. metres (668.2 sq. feet)

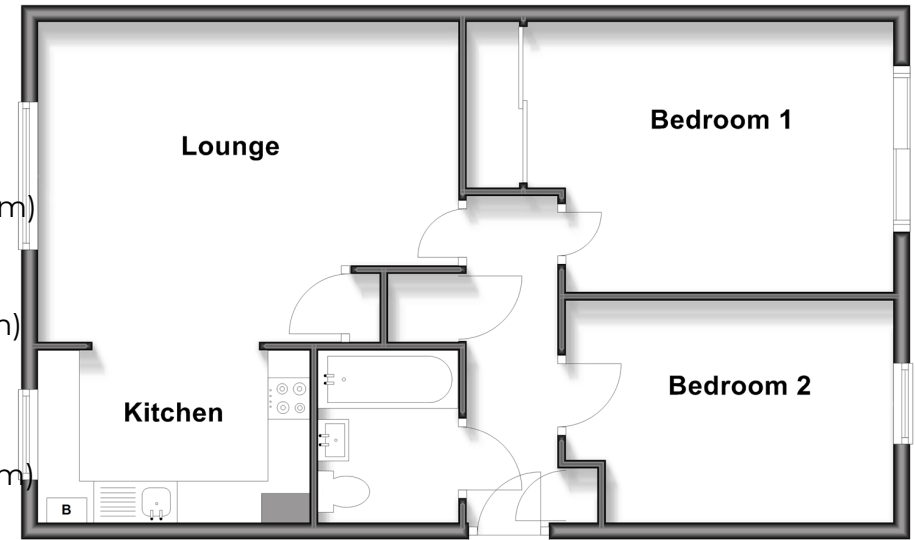

Call Eynsford - 01322 862844 ■ wardsofkent.co.uk

- Legal advice should be taken to verify fixtures/fittings, planning, alterations and/or lease details
- Appliances & services are untested, dimensions are approximate and floor plans are not to scale
- Through a Homewise Home For Life Plan people aged 60+ can secure this property for up to 50% less, by purchasing a Lifetime Lease.



12520358/20250916/HS/MF