



**Price**  
**£325,000**

**Leasehold**

3x  1x  1x 

**The Gateway, Dover,  
Kent, CT16**

**OVER 60?**

Secure this property  
for up to **59% less!**

*Wards*  
Helping you move forwards



## Main features

- Wonderful third floor apartment
- No onward chain complications
- Breathtaking sea views over the English Channel
- Close to both Dover town and Dover Marina
- Residents parking

## Accommodation

### THIRD FLOOR

Entrance Hallway

Lounge : 19'4 x 12'2 (5.90m x 3.71m)

Balcony

Dining Area : 9'6 x 6'3 (2.90m x 1.91m)

Kitchen : 11'0 x 6'8 (3.36m x 2.03m)

Separate Toilet

Family Bathroom

Bedroom 1 : 12'0 x 9'3 (3.66m x 2.82m)

Bedroom 2 : 11'7 x 8'1 (3.53m x 2.47m)

Bedroom 3 : 10'8 x 7'3 (3.25m x 2.21m)

### OUTSIDE

Residents Parking

Communal Gardens

**Third Floor**  
Approx. 87.1 sq. metres (937.7 sq. feet)

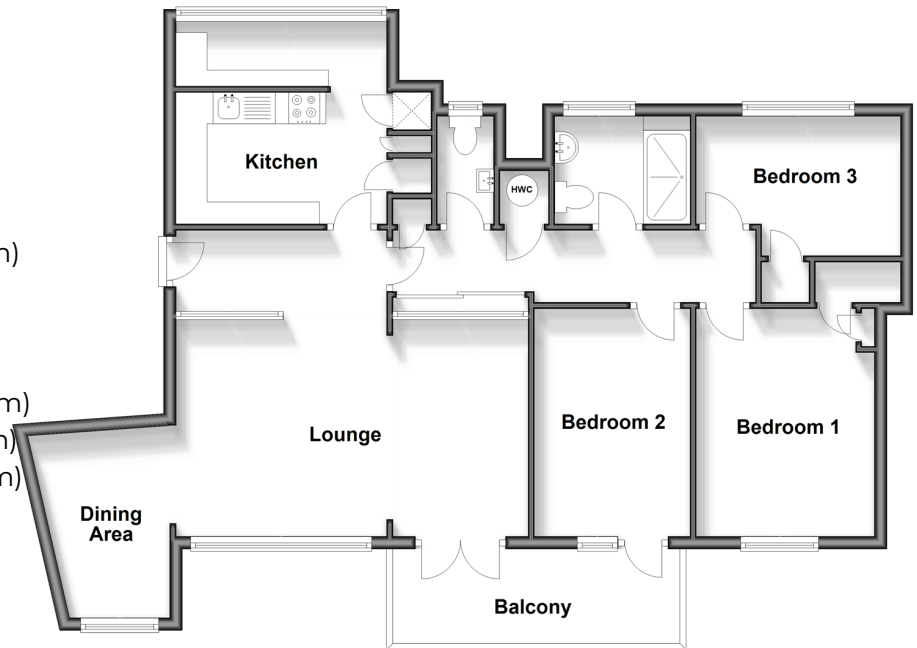

**Call Dover - 01304 214876 ■ [wardsofKent.co.uk](http://wardsofKent.co.uk)**

- Legal advice should be taken to verify fixtures/fittings, planning, alterations and/or lease details
- Appliances & services are untested, dimensions are approximate and floor plans are not to scale
- Through a Homewise Home For Life Plan people aged 60+ can secure this property for up to 59% less, by purchasing a Lifetime Lease.



10735569/20240601/TE/CB