



Guide Price
£375,000

Freehold

2x  1x  3x 

**Sandwich Road, River,
Dover, Kent, CT16**

OVER 60?

Secure this property
for up to **59% less!**

Wards
Helping you move forwards



Main features

- **1930'S house in sought after location**
- **No onward chain complications**
- **Garage and plenty of off road parking**
- **Whitfield is ideally positioned for commuting with easy access to A256 and A2/M2**
- **Close to Dover, Deal, Folkestone and Canterbury towns**

Accommodation

GROUND FLOOR

Entrance Lobby
 Entrance Hallway
 Lounge : 12'4 x 11'9 (3.76m x 3.58m)
 Bedroom 1: 12'4 x 11'9 (3.76m x 3.58m)
 Bedroom 2 : 12'0 x 11'9 (3.66m x 3.58m)
 Shower Room : 6'1 x 5'9 (1.86m x 1.75m)
 Separate Cloakroom
 Dining Room : 11'9 x 9'8 (3.58m x 2.95m)
 Kitchen : 10'3 x 8'4 (3.13m x 2.54m)
 Conservatory: 12'5 x 6'1 (3.79m x 1.86m)

OUTSIDE

Front Garden
 Rear Garden
 Off Road Parking
 Garage
 Garden Shed And Green House

Ground Floor

Approx. 94.7 sq. metres (1019.2 sq. feet)

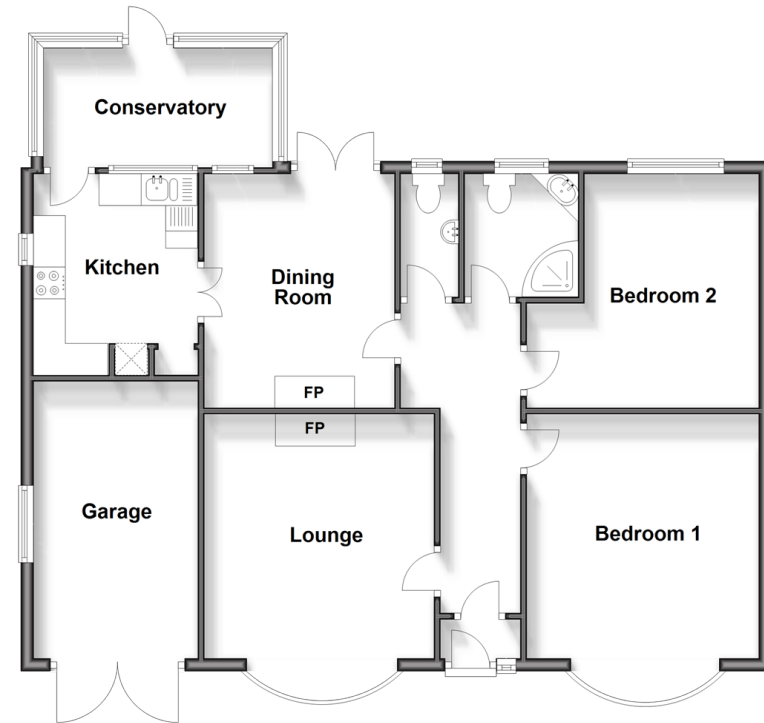

Call Dover - 01304 214876 ■ wardsof Kent.co.uk

■ Legal advice should be taken to verify fixtures/fittings, planning, alterations and/or lease details
 ■ Through a Homewise Home For Life Plan people aged 60+ can secure this property for up to 59% less, by purchasing a Lifetime Lease.

■ Appliances & services are untested, dimensions are approximate and floor plans are not to scale



10735543/20240521/GH/OV