



OVER 60?

Secure this property
for up to **59% less!**

Price

£230,000

Leasehold

2x  1x  1x 

**Ethelbert Road,
Cliftonville, Margate,
Kent, CT9**

Wards
Helping you move forwards



Main features

- Excellent condition throughout
- Desirable location with the sea at the bottom of the road
- No onward chain
- This would be a fantastic first time purchase or a second home by the sea
- Enjoy your own private outside space in the courtyard

Accommodation

LOWER GROUND FLOOR

Hallway

Kitchen/Lounge: 16'8 x 13'2 (5.08m x 4.02m)

Bathroom

Bedroom 1: 14'8 x 12'1 (4.47m x 3.69m)

Bedroom 2: 8'9 x 8'3 (2.67m x 2.52m)

OUTSIDE

Courtyard Garden

Lower Ground Floor

Approx. 50.1 sq. metres (538.8 sq. feet)

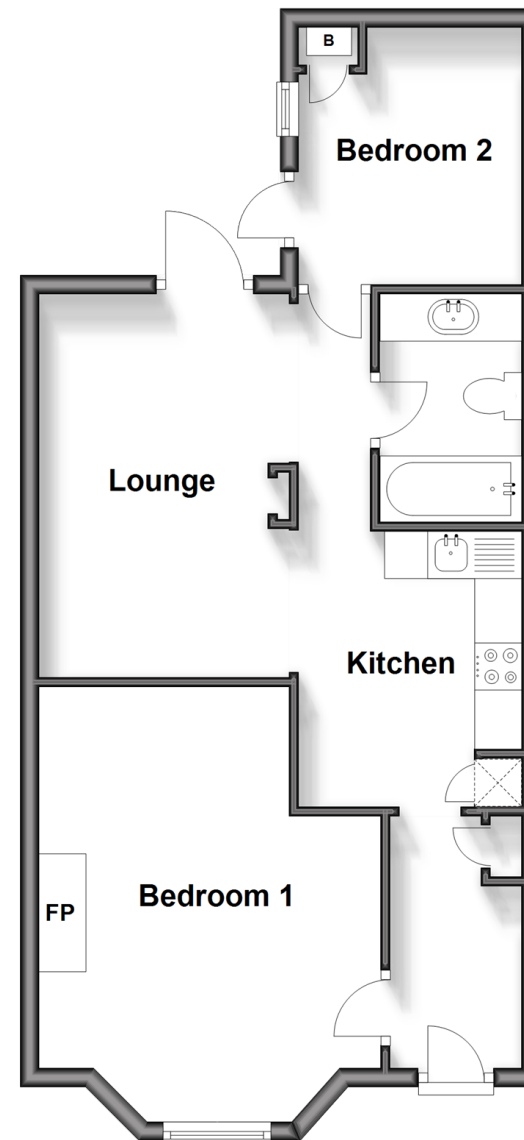

Call Cliftonville - 01843 227447 ■ wardsofkent.co.uk

- A private rental licensing scheme applies to some properties in this area, please contact us before proceeding
- Legal advice should be taken to verify fixtures/fittings, planning, alterations and/or lease details
- Appliances & services are untested, dimensions are approximate and floor plans are not to scale
- Through a Homewise Home For Life Plan people aged 60+ can secure this property for up to 59% less, by purchasing a Lifetime Lease.



15108668/20240930/DM/VH