



Price
£795,000

Freehold

4x  2x  2x 

**The Street, Detling,
Maidstone, Kent, ME14**

OVER 60?

Secure this property
for up to **59% less!**

Wards
Helping you move forwards



Main features

- **Stunning private position, surrounded by gardens and overlooking fields**
- **Generously proportioned throughout**
- **Private driveway leading to large parking area**
- **Detached double garage**
- **Conveniently positioned for all the village offers with nearby church and pub**

Accommodation

SPLIT LEVEL GROUND FLOOR

Entrance Hall

Lounge: 30'0 x 18'0 (9.40m x 5.49m)

Dining Area: 13'0 x 11'7 (3.97m x 3.53m)

Conservatory

Kitchen/Breakfast Room: 14'4 x 12'10 (4.37m x 3.91m)

Utility Room: 9'8 x 7'6 (2.95m x 2.29m)

Bedroom 1: 15'0 x 12'11 (4.58m x 3.94m)

En-suite Bathroom: 9'6 x 7'9 (2.90m x 2.36m)

Bedroom 2: 13'2 x 12'8 (4.02m x 3.86m)

Bedroom 3: 13'6 x 7'11 (4.12m x 2.41m)

Bedroom 4: 10'1 x 9'7 (3.08m x 2.92m)

Bathroom: 7'6 x 7'4 (2.29m x 2.24m)

OUTBUILDINGS

Detached Double Garage

OUTSIDE

Front and Rear Gardens

Off Road Parking

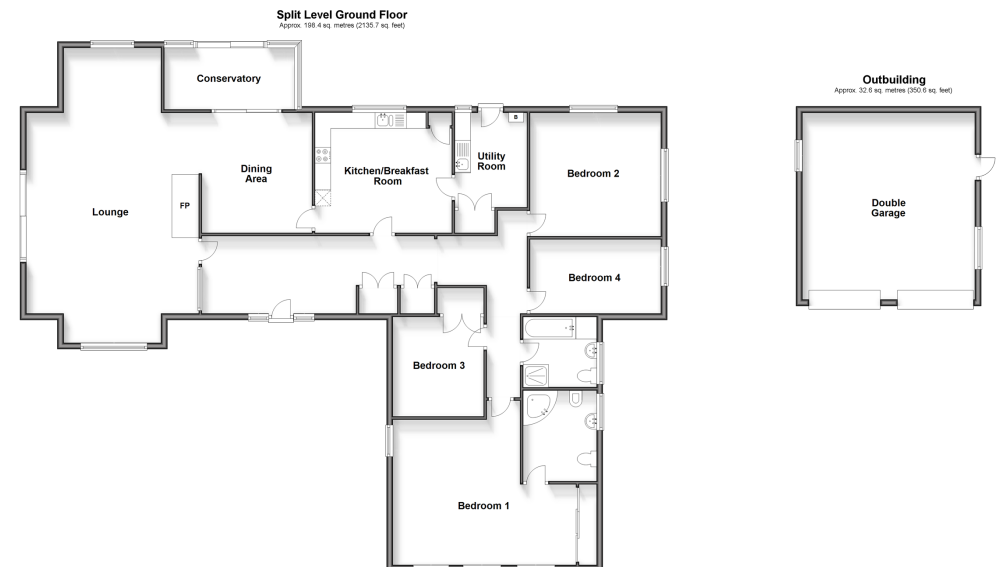

Call Bearsted - 01622 730955 ■ wardsofkent.co.uk

- Legal advice should be taken to verify fixtures/fittings, planning, alterations and/or lease details
- Through a Homewise Home For Life Plan people aged 60+ can secure this property for up to 59% less, by purchasing a Lifetime Lease.

- Appliances & services are untested, dimensions are approximate and floor plans are not to scale



12328852/20240629/SG/MC