

**OVER 60?**

Secure this property  
for up to **59% less!**



**Price**

**£310,000**

**Freehold**

2x  1x  1x 

Orchard Road, Shanklin, Isle of Wight,

PO37

**Pittis**   
Helping you move forwards



## Ground Floor

Approx. 101.1 sq. metres (1088.2 sq. feet)

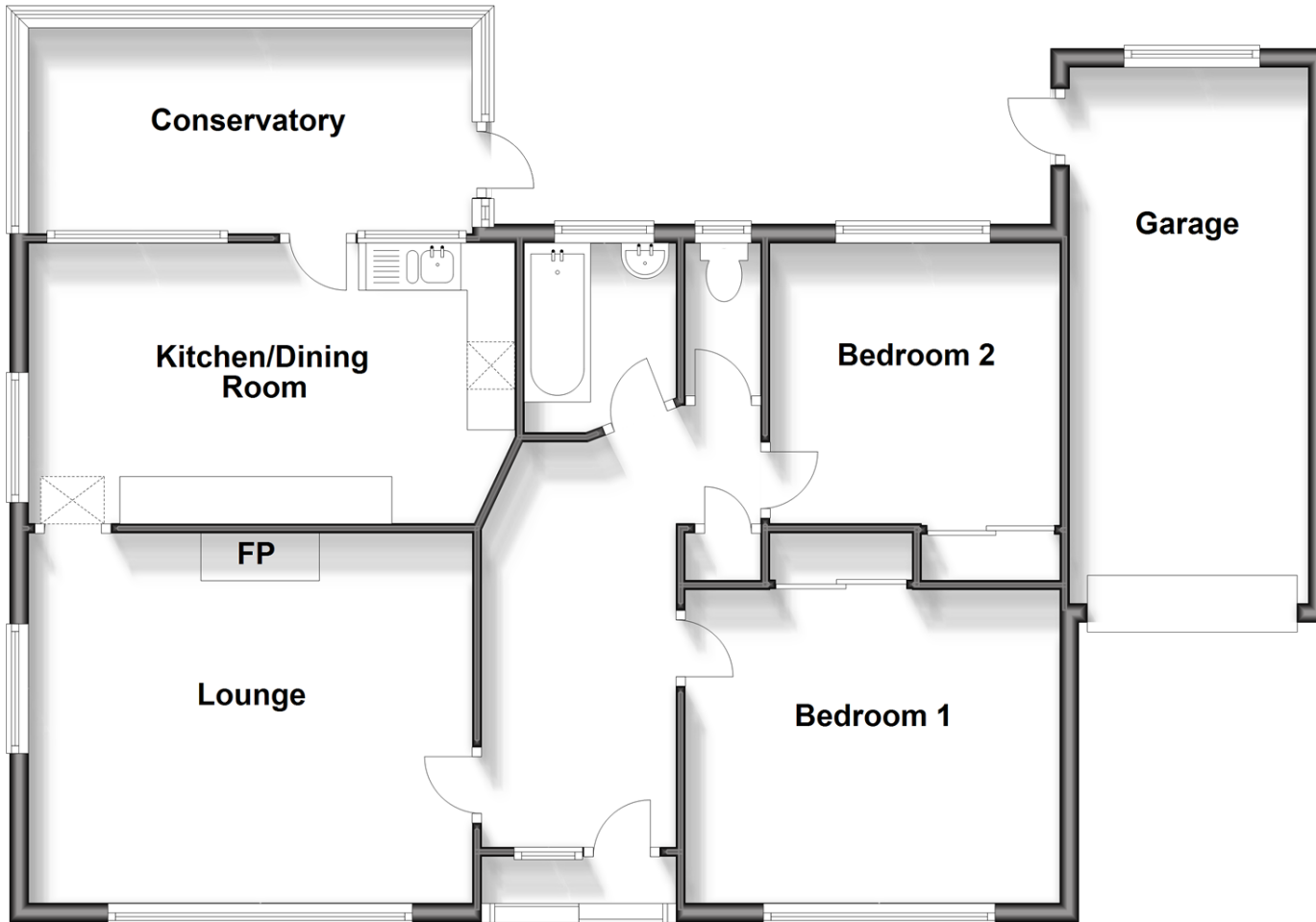

## Accommodation

### GROUND FLOOR

Hallway

Bedroom 1: 13'0 x 10'9 (3.97m x 3.28m)

Bedroom 2: 9'10 x 9'8 (3.00m x 2.95m)

Separate Toilet

Bathroom

Kitchen/Dining Room: 16'8 x 9'9 (5.08m x 2.97m)

Conservatory

Lounge: 15'4 x 12'0 (4.68m x 3.66m)

### OUTSIDE

Garage & Driveway

Front & Rear Gardens



## Main features

- Detached bungalow in a popular sought after area on the outskirts of Shanklin
- In need of some modernisation
- Lovely wood burning stove in the lounge
- Good sized and productive garden to the rear
- Garage & driveway, chain free sale

### Nearest Schools

Primary Schools: Lake Middle School 2.1 miles, Sandham Middle School 3.1 miles, Ventnor Middle School 4.2 miles

Secondary Schools: Priory School 1.2 miles, Sandown High School 3.1 miles, St Catherine's School 4.5 miles

### Transport Information

Train Stations: Shanklin 1.1 miles, Lake 2.1 miles, Sandown 2.9 miles

### Address

Orchard Road, Shanklin, Isle of Wight, PO37

### Directions

For directions to this property please contact us.



