



Price
£180,000

Leasehold

2x  1x  1x 

**Silcombe Court, Colwell
Lane, Freshwater, Isle of
Wight, PO40**

OVER 60?

Secure this property
for up to **59% less!**

Pittis 
Helping you move forwards



Main features

- Ground floor apartment with private garden and off road parking
- Conservatory to the rear great play area or dining room
- Walking distance to Colwell Bay and Freshwater village
- Light and airy throughout
- Ideal first time purchase or investment property

Accommodation

GROUND FLOOR

Hallway

Lounge: 11'4 x 10'6 (3.46m x 3.20m)

Kitchen: 8'10 x 5'10 (2.69m x 1.78m)

Conservatory: 8'2 x 7'7 (2.49m x 2.31m)

Bedroom 1: 10'6 x 10'2 (3.20m x 3.10m)

Bedroom 2: 8'6 x 8'5 (2.59m x 2.57m)

OUTSIDE

Allocated Parking
Large Rear Garden

Ground Floor

Approx. 53.2 sq. metres (573.1 sq. feet)

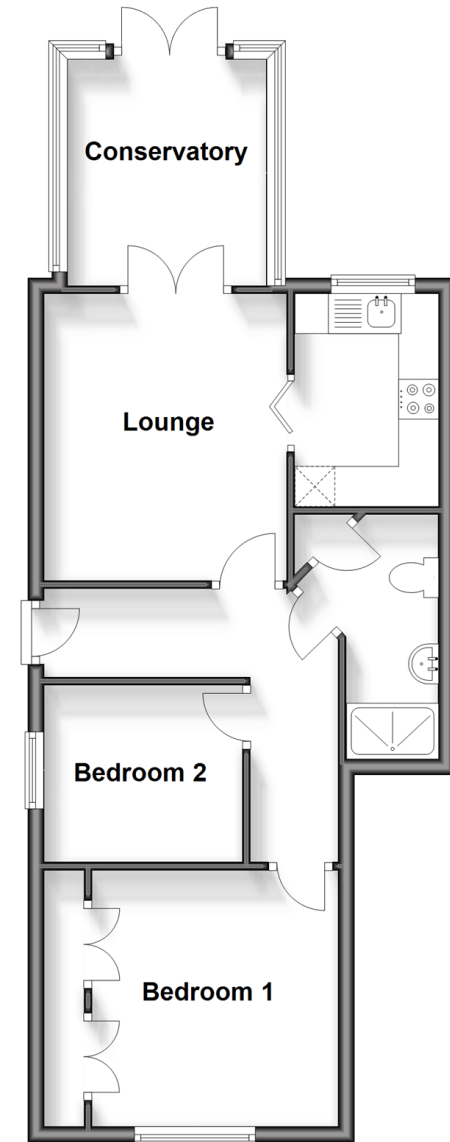

Call Freshwater - 01983 756222 ■ pittis.co.uk

- Legal advice should be taken to verify fixtures/fittings, planning, alterations and/or lease details
- Appliances & services are untested, dimensions are approximate and floor plans are not to scale
- Through a Homewise Home For Life Plan people aged 60+ can secure this property for up to 59% less, by purchasing a Lifetime Lease.



60218452/20241116/CG/CG