



Price

£395,000

Freehold

3x  1x  1x 

**Queens Road,
Freshwater, Isle of
Wight, PO40**

OVER 60?

Secure this property
for up to **59% less!**

Pittis 
Helping you move forwards



Main features

- **Detached bungalow set on the fringe of the village**
- **Open plan living area and modern kitchen**
- **Log burner**
- **Attractive garden with decked area**
- **Beautifully located for walks across the Downs and the local beach**

Accommodation

GROUND FLOOR

- Hallway
- Lounge/ Dining Area: 19'4 x 10'9 (5.90m x 3.28m)
- Kitchen Area: 15'5 x 9'5 (4.70m x 2.87m)
- Conservatory/Utility Area: 14'4 x 5'0 (4.37m x 1.53m)
- Bedroom 2: 10'9 x 9'8 (3.28m x 2.95m)
- Bedroom 1: 11'2 x 10'8 (3.41m x 3.25m)
- Bedroom 3: 10'8 x 9'8 (3.25m x 2.95m)
- Shower Room

OUTSIDE

- Front Garden
- Driveway
- Rear Garden
- Summer House

Ground Floor
Approx. 86.5 sq. metres (931.6 sq. feet)

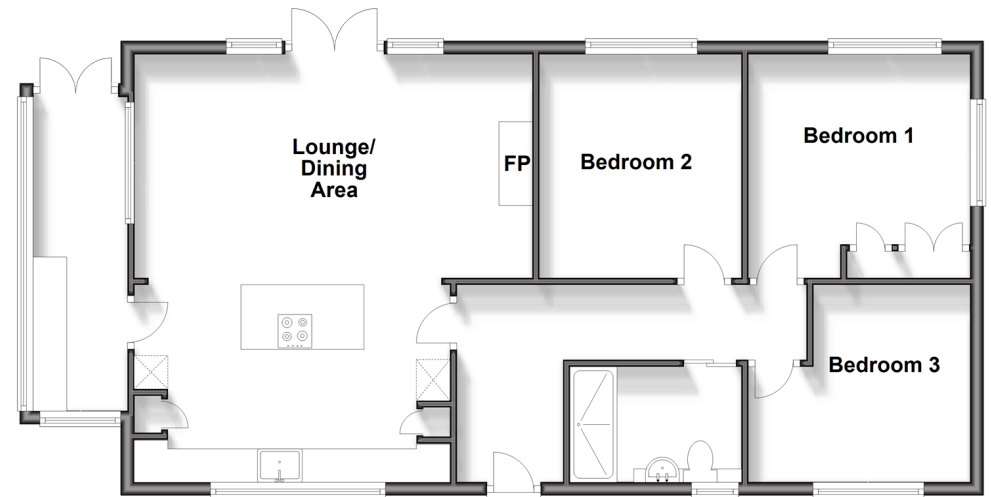

Call Freshwater - 01983 756222 ■ pittis.co.uk

- Legal advice should be taken to verify fixtures/fittings, planning, alterations and/or lease details
- Through a Homewise Home For Life Plan people aged 60+ can secure this property for up to 59% less, by purchasing a Lifetime Lease.

- Appliances & services are untested, dimensions are approximate and floor plans are not to scale



60218428/20241105/SC1/EP