



Price
£345,000

Freehold

2x  1x  1x 

Summers Lane, Totland
Bay, Isle of Wight, PO39

OVER 60?

Secure this property
for up to **59% less!**

Pittis 
Helping you move forwards



Main features

- Beautifully presented detached bungalow
- Wrap around gardens with driveway parking
- Recently upgraded boiler generous sized rooms
- Has been in the family for over 40 years
- In a lovely village location

Accommodation

GROUND FLOOR

Kitchen : 11'3 x 9'4 (3.43m x 2.85m)

Lounge: 16'0 x 11'9 (4.88m x 3.58m)

Bedroom 1: 13'8 x 11'9 (4.17m x 3.58m)

Bedroom 2: 11'0 x 7'8 (3.36m x 2.34m)

Bathroom

OUTSIDE

Driveway

Wrap Around Gardens

Ground Floor

Approx. 63.1 sq. metres (679.5 sq. feet)

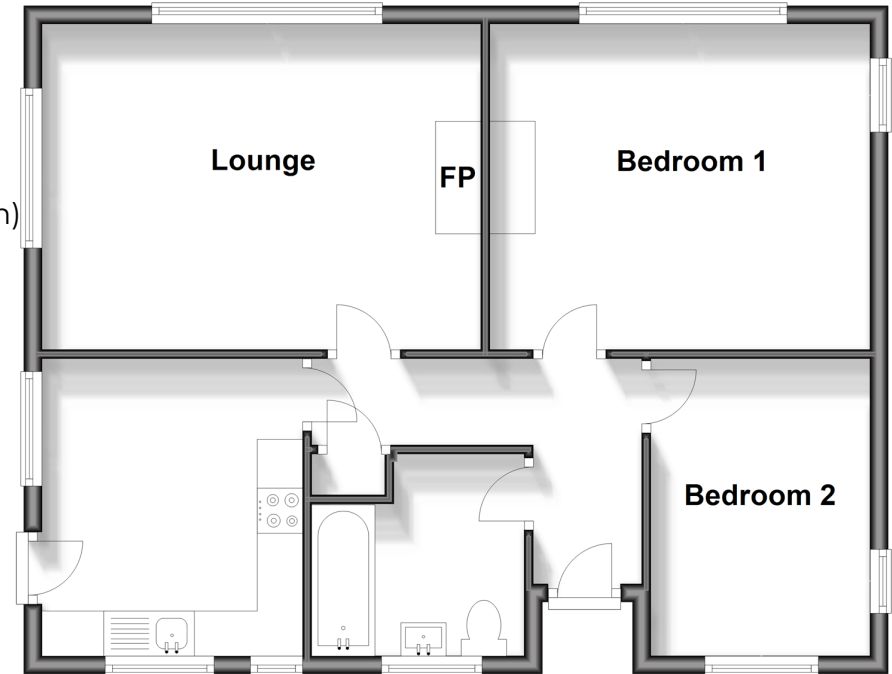

Call Freshwater - 01983 756222 ■ pittis.co.uk

- Legal advice should be taken to verify fixtures/fittings, planning, alterations and/or lease details
- Appliances & services are untested, dimensions are approximate and floor plans are not to scale
- Through a Homewise Home For Life Plan people aged 60+ can secure this property for up to 59% less, by purchasing a Lifetime Lease.



60218238/20240315/JB/EP