



**Price**  
**£600,000**

**Freehold**

3x  1x  2x 

**Naseby Road, Ilford,  
Essex, IG5**

**OVER 60?**

Secure this property  
for up to **59% less!**

 **DOUGLAS  
ALLEN**  
Helping you move forwards





## Main features

- Extended semi-detached house
- Large kitchen/diner
- Modern and superbly presented throughout
- Large workshop in a beautiful landscaped rear garden
- Excellent school catchment including Beale High School

## Accommodation

### GROUND FLOOR

- Entrance Porch
- Hallway
- Lounge: 14'7 x 11'5 (4.45m x 3.48m)
- Dining Area: 11'5 x 10'3 (3.48m x 3.13m)
- Kitchen/Breakfast Area: 17'0 x 10'1 (5.19m x 3.08m)
- Utility Room
- Cloakroom

### FIRST FLOOR

- Landing
- Bedroom 1: 12'5 up to fitted wardrobes x 10'9 (3.79m x 3.28m)
- Bedroom 2: 14'7 x 8'7 (4.45m x 2.62m)
- Bedroom 3: 7'8 x 6'6 (2.34m x 1.98m)
- Bathroom

### OUTBUILDING

- Room 1
- Room 2

### OUTSIDE

- Off Street Parking
- Rear Garden

Call Woodford Green - 020 8505 6343 ■ [douglasallen.co.uk](http://douglasallen.co.uk)

- Legal advice should be taken to verify fixtures/fittings, planning, alterations and/or lease details
- Appliances & services are untested, dimensions are approximate and floor plans are not to scale
- Through a Homewise Home For Life Plan people aged 60+ can secure this property for up to 59% less, by purchasing a Lifetime Lease.

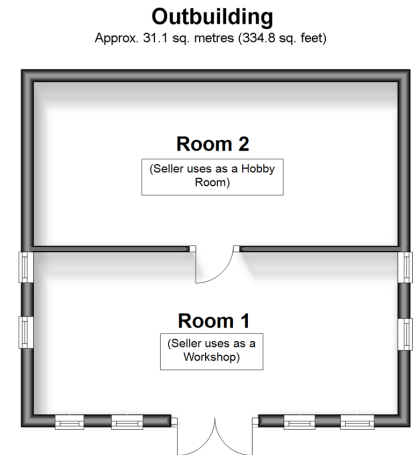
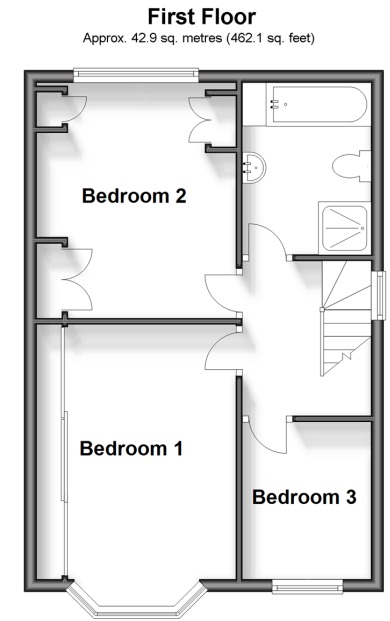
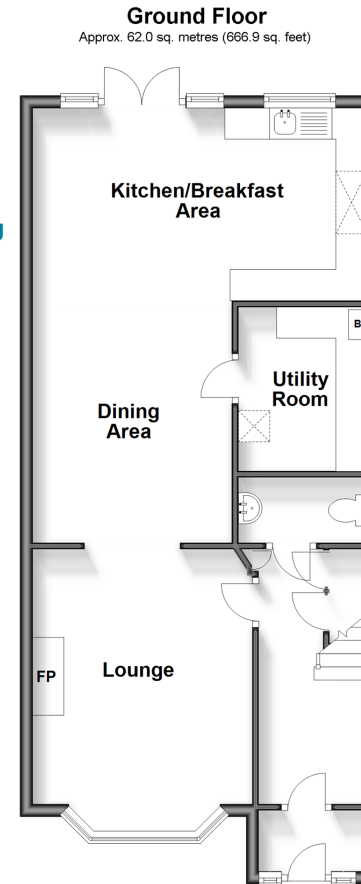

53619007/20241101/AMA/SP