



Price

£500,000

Freehold

4x  1x  1x 

**Lower Park Road,
Wickford, Essex, SS12**

OVER 60?

Secure this property
for up to **59% less!**

 **DOUGLAS
ALLEN**
Helping you move forwards

Ground Floor

Approx. 143.8 sq. metres (1547.9 sq. feet)

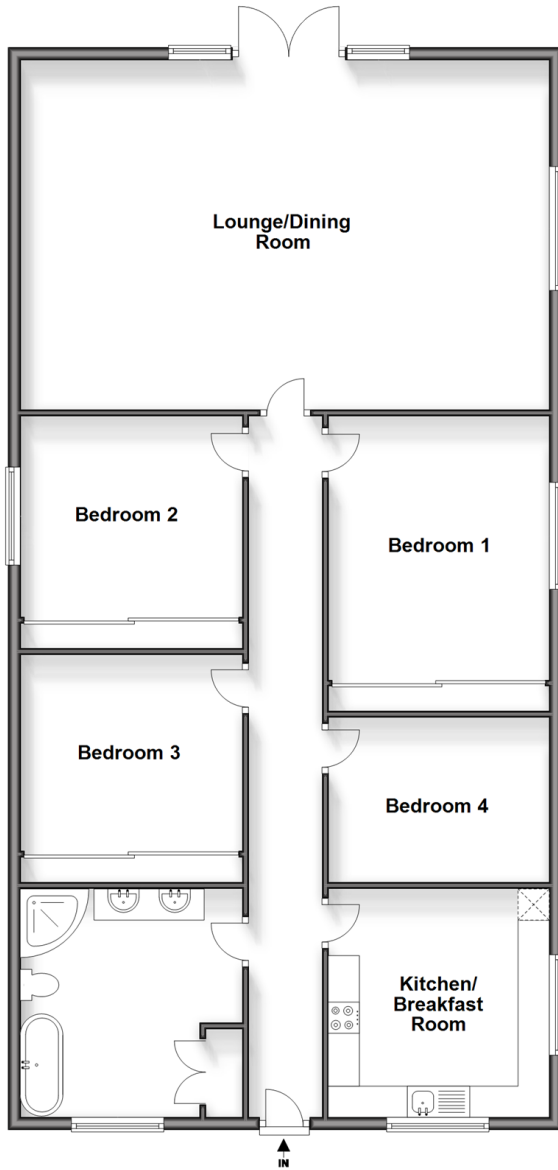

Annexe

Approx. 72.4 sq. metres (779.2 sq. feet)

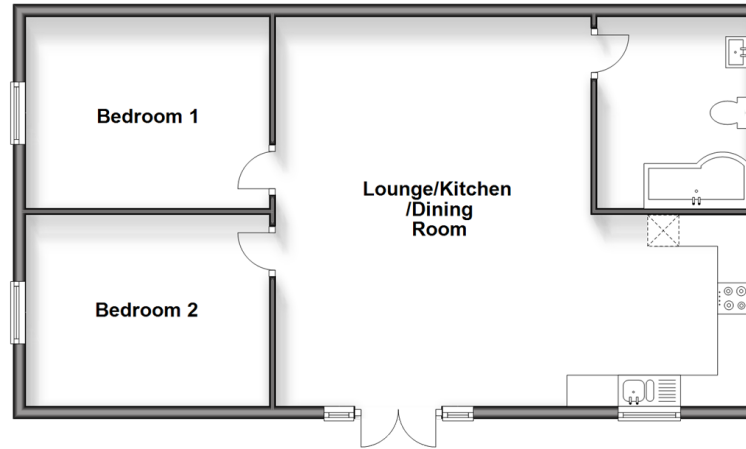

Accommodation

GROUND FLOOR

Entrance Hallway

Lounge/Dining Room: 28'2 x 18'5 (8.59m x 5.62m)

Kitchen: 11'11 x 11'8 (3.63m x 3.56m)

Bedroom 1 : 13'2 x 11'9 (4.02m x 3.58m)

Bedroom 2 : 11'8 x 10'0 (3.56m x 3.05m)

Bedroom 3 : 11'8 x 10'0 (3.56m x 3.05m)

Bedroom 4: 11'9 x 8'8 (3.58m x 2.64m)

Bathroom

OUTSIDE

Rear Garden

Off Street Parking

Triple Garage/Workshop: 42'10 x 23'10
(13.06m x 7.27m)

ANNEXE

Lounge: 20'3 x 16'8 (6.18m x 5.08m)

Kitchen: 9'11 x 9'11 (3.02m x 3.02m)

Bedroom 1: 12'9 x 9'11 (3.89m x 3.02m)

Bedroom 2: 12'9 x 9'11 (3.89m x 3.02m)

Bathroom



Main features

- Four bedroom detached bungalow
- Triple garage/workshop
- Two bedroom annexe to rear
- Large plot with potential
- Gated property with off street parking for several vehicles



Nearest Schools

Primary Schools: Oakfield Primary 0.5 miles, Grange Primary 0.7 miles, Abacus Primary 0.7 miles

Secondary Schools: Castledon School 0.5 miles, The Bromfords School 0.6 miles, Beauchamps High School 1.4



Transport Information

Train Stations: Wickford 1.6 miles, Battlesbridge 4.0 miles, Benfleet 4.1 miles



Address

Lower Park Road, Wickford, Essex, SS12



Directions

For directions to this property please contact us.



Call Wickford Branch 01268 561287 ■ [douglasallen.co.uk](https://www.douglasallen.co.uk)



- Legal advice should be taken to verify fixtures/fittings, planning, alterations and/or lease details
- Appliances & services are untested, dimensions are approximate and floor plans are not to scale
- Through a Homewise Home For Life Plan people aged 60+ can secure this property for up to 59% less, by purchasing a Lifetime Lease.

EPC RATING Lightbulb icon 100% scale	CURRENT: C(74)	POTENTIAL: B(89)
	53412831/20241009/LC/LC	