



Price
£550,000

Freehold

3x  1x  1x 

**Burwell Road, Leyton,
E10**

 **DOUGLAS
ALLEN**
Helping you move forwards



Main features

- Chain free
- Period family home
- Double bedrooms and good sized living rooms
- Fantastic location
- Well maintained rear garden

Accommodation

GROUND FLOOR

Lounge: 13'7 x 10'8 (4.14m x 3.25m)

Dining Room: 11'2 x 9'5 (3.41m x 2.87m)

Kitchen: 7'1 x 6'3 (2.16m x 1.91m)

FIRST FLOOR

Bedroom 1: 13'8 x 8'4 (4.17m x 2.54m)

Bedroom 2: 11'5 x 8'4 (3.48m x 2.54m)

Bedroom 3: 7'8 x 6'1 (2.34m x 1.86m)

Bathroom

OUTSIDE

Front Garden

Rear Garden

Ground Floor

Approx. 34.9 sq. metres (376.1 sq. feet)

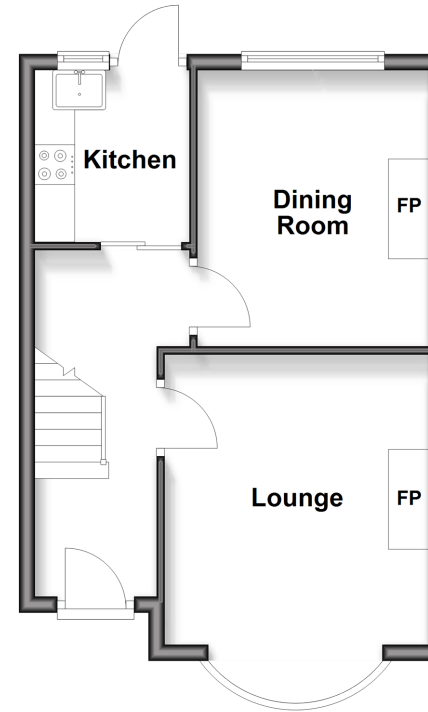

First Floor

Approx. 35.9 sq. metres (386.6 sq. feet)

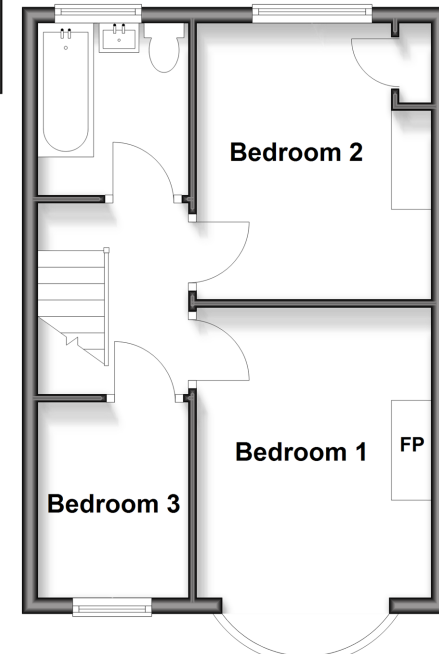

Call Walthamstow - 020 8509 0092 ■ douglasallen.co.uk

- A private rental licensing scheme applies to some properties in this area, please contact us before proceeding
- Legal advice should be taken to verify fixtures/fittings, planning, alterations and/or lease details
- Appliances & services are untested, dimensions are approximate and floor plans are not to scale



53117769/20250329/KS/S