



Guide Price
£650,000

Freehold

3x  1x  1x 

**Lewis Avenue,
Walthamstow, London,
E17**

 **DOUGLAS
ALLEN**
Helping you move forwards



Main features

- End of terrace house in cul-de-sac
- Offered chain free
- Garage & additional land
- Through lounge
- Separate kitchen
- Modern bathroom
- Close to Lloyd Park, A406, M11 and Sir George Monoux College

Accommodation

GROUND FLOOR

Lounge: 11'2 x 10'8 (3.41m x 3.25m)
 Living Room: 11'6 x 9'1 (3.51m x 2.77m)
 Kitchen: 8'7 x 7'7 (2.62m x 2.31m)

FIRST FLOOR

Bedroom 1: 13'6 x 11'3 (4.12m x 3.43m)
 Bedroom 2: 11'2 x 8'8 (3.41m x 2.64m)
 Bedroom 3: 9'10 x 5'6 (3.00m x 1.68m)
 Bathroom: 5'9 x 5'7 (1.75m x 1.70m)

OUTSIDE

Driveway
 Garage
 Rear Garden
 Extra Land

Ground Floor

Approx. 37.1 sq. metres (399.7 sq. feet)

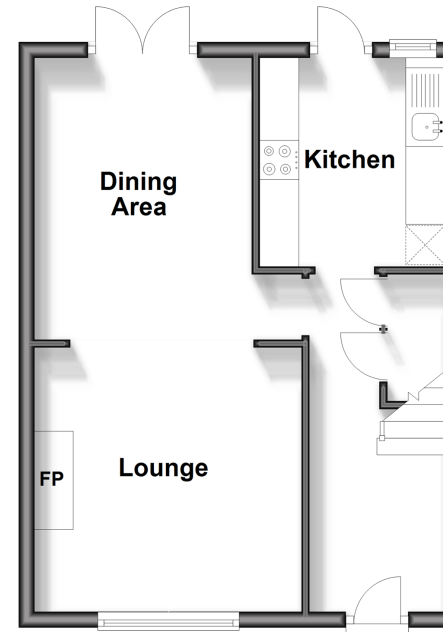

First Floor

Approx. 37.1 sq. metres (399.7 sq. feet)



Call Walthamstow - 020 8509 0092 ■ douglasallen.co.uk

- A private rental licensing scheme applies to some properties in this area, please contact us before proceeding
- Legal advice should be taken to verify fixtures/fittings, planning, alterations and/or lease details
- Appliances & services are untested, dimensions are approximate and floor plans are not to scale



53116531/20241102/KS/DM