



**Price**

**£180,000**

**Leasehold**

1x  1x  1x 

**King Harold Lodge,  
Broomstick Hall Road,  
Waltham Abbey, Essex,  
EN9**



## Main features

- Ground floor retirement flat
- On site Lodge Manager during office hours
- 24 hour care line support
- Communal residents lounge
- Lift to all floors
- Rentable guest room for visiting relatives
- The central heating is included

## Accommodation

### GROUND FLOOR

Entrance Hall

Lounge/Diner: 19'5 x 10'5 (5.92m x 3.18m)

Kitchen : 8'0 x 7'8 (2.44m x 2.34m)

Bedroom : 15'6 x 9'1 (4.73m x 2.77m)

Shower Room

### OUTSIDE

Communal Garden

### Ground Floor

Approx. 48.8 sq. metres (525.7 sq. feet)

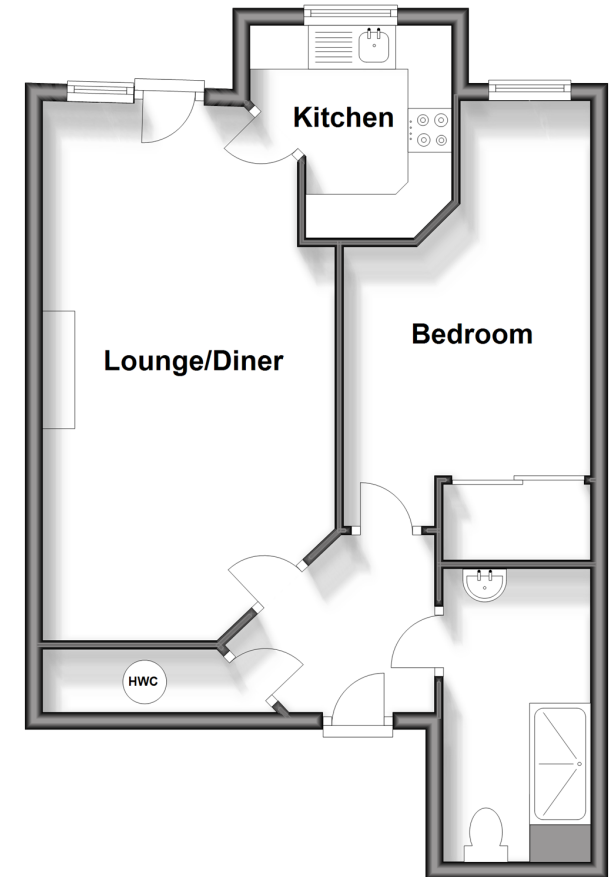

**Call Loughton - 020 8502 1326 ■ [douglasallen.co.uk](http://douglasallen.co.uk)**

- Legal advice should be taken to verify fixtures/fittings, planning, alterations and/or lease details
- Appliances & services are untested, dimensions are approximate and floor plans are not to scale