



Price

£205,000

Leasehold

1x  1x  1x 

Osprey Court, Osprey
Road, Waltham Abbey,
Essex, EN9

OVER 60?

Secure this property
for up to **59% less!**

 **DOUGLAS
ALLEN**
Helping you move forwards



Main features

- First floor purpose built flat with allocated parking
- Excellent condition
- Ideal for investors or first time buyers
- Short drive or bus ride to Waltham Abbey town centre
- Close to Epping Forest
- Easy access to the M25

Accommodation

FIRST FLOOR

Entrance Hall

Lounge/Dining Area: 13'0 x 9'9
(3.97m x 2.97m)

Kitchen: 8'6 x 5'11 (2.59m x 1.80m)

Bedroom: 10'8 x 9'10 (3.25m x 3.00m)

Bathroom

OUTSIDE

Allocated Parking

Communal Gardens

First Floor

Approx. 37.9 sq. metres (408.1 sq. feet)

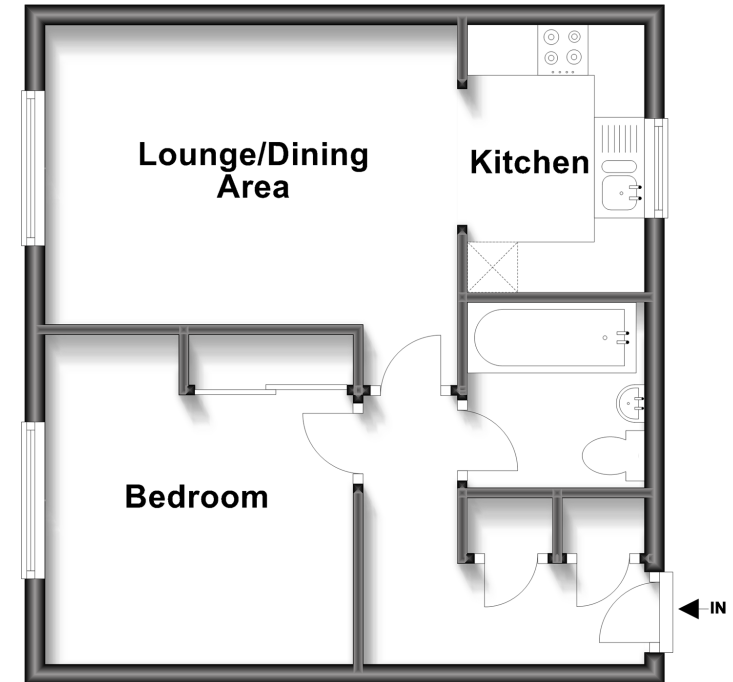

Call Loughton - 020 8502 1326 ■ douglasallen.co.uk

- A private rental licensing scheme applies to some properties in this area, please contact us before proceeding
- Legal advice should be taken to verify fixtures/fittings, planning, alterations and/or lease details
- Appliances & services are untested, dimensions are approximate and floor plans are not to scale
- Through a Homewise Home For Life Plan people aged 60+ can secure this property for up to 59% less, by purchasing a Lifetime Lease.



52317245/20240427/KA/LL