



Price

£120,000

Leasehold

2x  1x  1x 

**Friars Close, Ilford,
Essex, IG1**

OVER 60?

Secure this property
for up to **59% less!**

 **DOUGLAS
ALLEN**
Helping you move forwards



Main features

- Well presented ground floor purpose built flat
- 40% Share Ownership
- Spacious lounge/diner, ideal for family gatherings
- Perfect for any first time buyers
- Walking distance to Newbury Park station

Accommodation

GROUND FLOOR

Entrance Hall

Lounge/Dining Room: 22'3 x 10'7 (6.79m x 3.23m)

Kitchen: 9'4 x 6'8 (2.85m x 2.03m)

Bedroom 1: 11'2 x 9'3 (3.41m x 2.82m)

Bedroom 2: 10'2 x 9'0 (3.10m x 2.75m)

Shower Room

OUTSIDE

Off Street Parking

Communal Gardens

Ground Floor

Approx. 56.9 sq. metres (612.1 sq. feet)

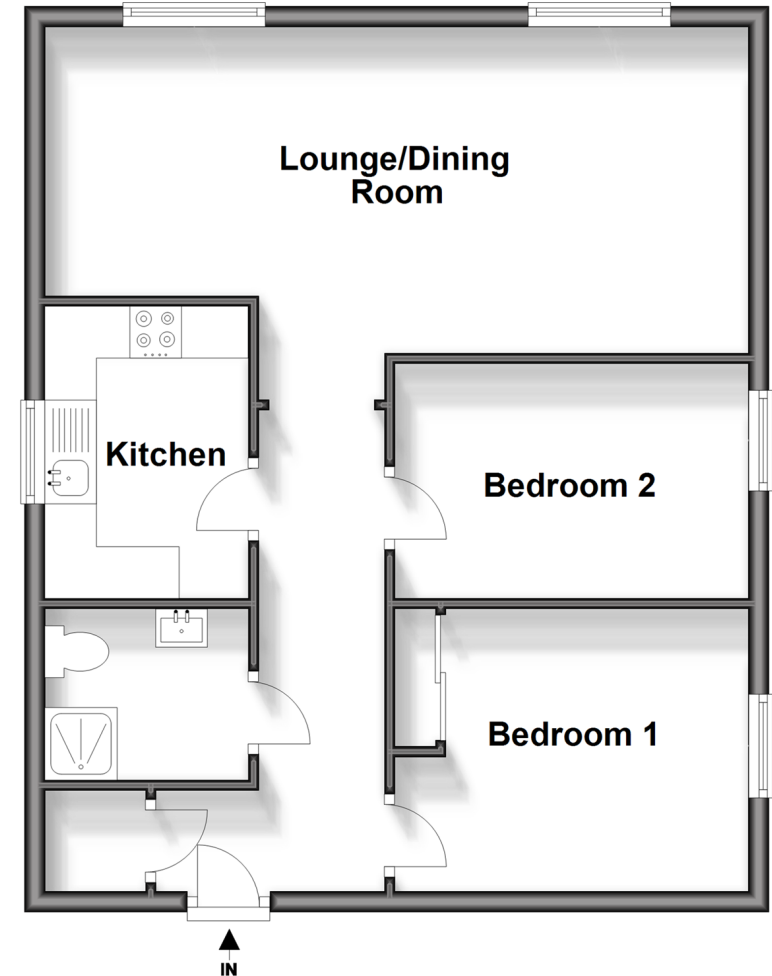

Call Ilford - 020 8518 0044 ■ douglasallen.co.uk

- Legal advice should be taken to verify fixtures/fittings, planning, alterations and/or lease details
- Appliances & services are untested, dimensions are approximate and floor plans are not to scale
- Through a Homewise Home For Life Plan people aged 60+ can secure this property for up to 59% less, by purchasing a Lifetime Lease.



52013633/20250201/CN/MS