



**Guide Price**  
**£125,000**

**Leasehold**

1x  1x  1x 

**Kingswood Court,  
Chingford Mount Road,  
Chingford, E4**





## Main features

- One-bedroom retirement apartment
- Spacious lounge and fitted kitchen
- Good decorative order throughout
- 24-hour support service for residents
- Close to shops, restaurants, and amenities of Chingford Mount
- Excellent transport links nearby

## Accommodation

### SECOND FLOOR

Lounge/Diner: 10'6 x 10'2 (3.20m x 3.10m)

Kitchen: 6'2 x 5'4 (1.88m x 1.63m)

Bedroom: 11'2 x 9'6 (3.41m x 2.90m)

Bathroom

### OUTSIDE

Communal Gardens

## Second Floor

Approx. 42.7 sq. metres (459.6 sq. feet)

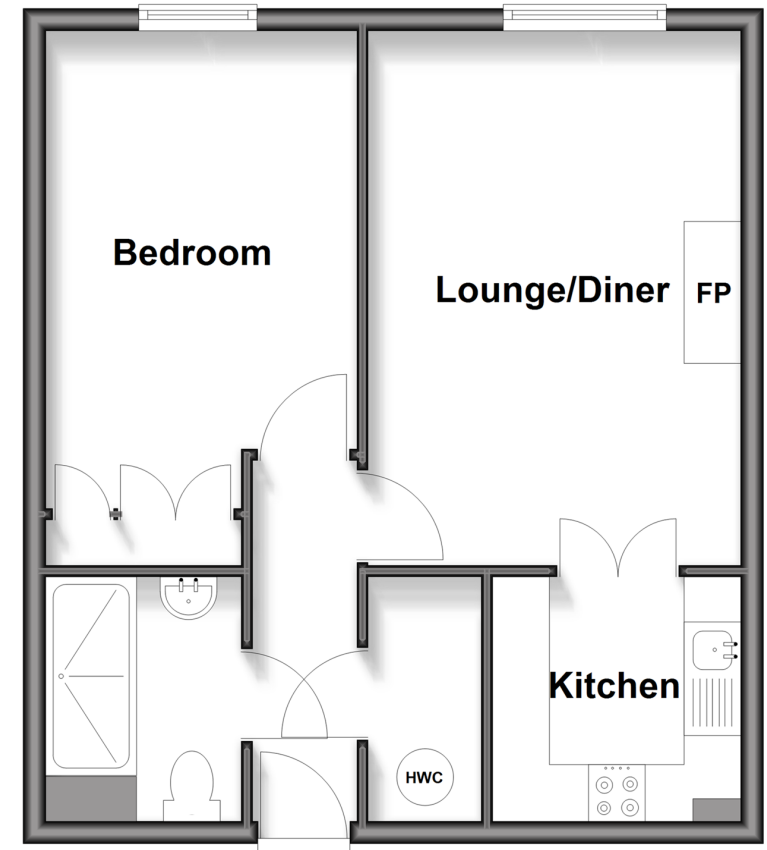

**Call Chingford - 020 8524 6331 ■ [douglasallen.co.uk](http://douglasallen.co.uk)**

- A private rental licensing scheme applies to some properties in this area, please check with the Local Authority before proceeding
- Legal advice should be taken to verify fixtures/fittings, planning, alterations and/or lease details
- Appliances & services are untested, dimensions are approximate and floor plans are not to scale



51013458/20260111/KS/SC